



# 2016 - 2017 **NEW PRODUCT** **HIGH PERFORMANCE**

**AIRCRAFT, INDUSTRIAL, ASSEMBLY,  
AUTOMOTIVE SOLUTION PNEUMATIC TOOLS**

**• INNOVATION • RESEARCH • DESIGN • QUALITY**  
**YOUR BEST BUSINESS PARTNER for THE BEST PERFORMANCE PNEUMATIC TOOLS**





# Top Quality And Absolute Precision

Our factory is ISO-9001 certified and air tool products CE certified. OBM / OEM and ODM orders are welcomed.

## Company Profile

Airpro Industry Corp. is a professional manufacturer and exporter with expertise for more than 20 years. We specialize in professional quality air tools, hand tools, & auto repair tools for automotive industry professional range.

Airpro Industry Corp always a few steps ahead of its competitors. We have provided reliable and most innovative tools worldwide, with thousands of products available, strictly controls its quality to ensure achievement of required performance.

Airpro Industry Corp. offering a one-stop shop for professional automotive industry tools.



■ Processed by high precise CNC machine, the assemblies-finished goods can achieve a reliable consistent of performances

■ Exhibit all product of tools, equipments with high-rate quality and reputation.

■ Professional colored box provide safety packing, improved technique and innovation design.

**CE** PROFESSIONAL  
 Our factory is ISO-9001 certified and products CE certified.

**ISO9001** **UKAS**  
 WCS QUALITY MANAGEMENT  
**VISION**  
 Become "the best solution and service provider" in the industry

**D&B** CERTIFICATE  
 D&B D-U-N-S® Registered™ Certified





## Product Range

Airpro Industry Corp. product line covers a wide range of CE certified tools and accessories, which includes 7 categories, and we just name a few.

**Aircraft Tools:** air rivet guns, angle drills, air drills, grinders & sanders, air hydraulic riveters, pneumatic squeezes, etc... and accessories.

**Industrial:** air impact wrenches, air sanders, air grinders, die grinders, waterfed abrasive air tools, air drills, screwdrivers, air hydraulic riveters & riveting nut tools, needle scalers, etc... and push start shut off air screwdrivers for furniture/electronic/computer on-site assembly application.

**Automotive:** oil-pulse tools for on-site assembly application; air impact wrenches, air ratchets, sanders & polishers, grinders, die grinders, drills, specialty air tools (air spot drills, air body saws, cut-off tool, air knife, air file, etc.) for auto repair/body workshop.

**Tooling / Molding:** micro die grinders, air lappers files, just to name a few.

**Construction / Boat:** air chipping hammers, air grinders, air flux chippers & needle scalers, sand rammers & pavement breakers, air hydraulic riveters, etc.

**Auto Body Shop Solution:** spray guns, air brushes, air tools for body shop, shop equipment & pressure pots, undercoating guns, body work tools, riveting tools, sandblasters, safety equipment, etc.

**Electronic Assembly Line:** air screwdrivers, cords & cordless screwdrivers...etc.

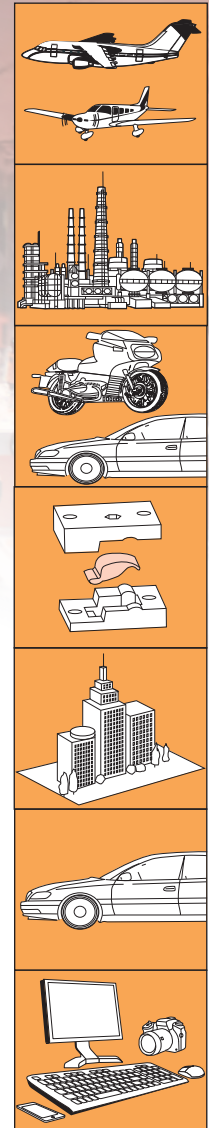

## Exhibition



# Gifts

高爾夫球帽  
Golf Cap



高爾夫球帽  
Golf Cap



背心  
Polo Shirt



背心  
Vest



手提袋  
Handbag



原子筆  
Ballpoint Pen



原子筆  
Ballpoint Pen



# Tool Display



Display Stand  
Duck Board &  
Peg Board



Air Tool  
Display Stand  
Size: 18x12x1.2cm



Air Tool Hook  
1/4" x19BSP or 18NPT



Display Hook  
Size: Ø: 3.8mm  
L: 50,100,150,200  
250,300mm



Socket Hangtag  
1/4", 3/8", 1/2",  
3/4", 1"DR Socket

# Catalog

New Product & Air Tool Catalog  
2015-2016  
2015-2016 NO.2 / 2015-2016 NO.3  
Spray Guns & Brushes &  
Pressures Pots  
2014-2015



Air Tool Catalog  
2014-2015 / 2015-2016

Riveter,  
Nut Riveter & Lockbolt  
2014-2015

Industrial Air Tool & Power Tool  
2014-2015





# Table Contents

01		<b>01</b>	<b>Air Impact Wrench</b> 氣動衝擊扳手
08		<b>08</b>	<b>Air Ratchet Wrench</b> 氣動棘輪扳手
09		<b>09</b>	<b>Air Sander, Polisher &amp; Belt Sander</b> 氣動砂光機, 打蠟機 & 砂帶機
15		<b>15</b>	<b>Professional Vacuum Cleaner</b> 吸塵器
16		<b>16</b>	<b>Air Micro Die Grinder &amp; Air Grinder</b> 筆型氣動刻模機 & 氣動研磨機
21		<b>21</b>	<b>Air Drill</b> 氣鑽
25		<b>25</b>	<b>Air Tapping Tool</b> 氣動攻牙機
26		<b>26</b>	<b>Air Screwdriver &amp; Torque Tester</b> 氣動螺絲起子 & 扭力測試機
29		<b>29</b>	<b>Special Air Tool</b> 特殊氣動工具
31		<b>31</b>	<b>Riveter, Nut Riveter &amp; Lockbolt Riveter</b> 拉釘槍, 拉帽槍 & 哈克槍
35		<b>35</b>	<b>Air Riveter Hammer</b> 氣動鉚釘鎚
36		<b>36</b>	<b>Air Flux Chipper &amp; Air Hammer</b> 氣動除鏽鎚 & 氣動鎚
37		<b>37</b>	<b>Low Noise Air Tool</b> 低噪音氣動工具
38		<b>38</b>	<b>Air Grease Gun, Air Caulking Gun &amp; Sand Blaster Gun</b> 氣動黃油槍, 填縫槍 & 噴砂槍
39		<b>39</b>	<b>Cleaning Gun</b> 清洗槍
40		<b>40</b>	<b>Air Blow Gun &amp; Suction Gun</b> 氣動吹塵 & 吸塵槍
45		<b>45</b>	<b>Digital Tire Inflator</b> 數位胎壓計
46		<b>46</b>	<b>Spring Balancer &amp; Tool Accessorie</b> 彈簧吊車 & 配件
50		<b>50</b>	<b>Water Base LVLP &amp; HVLP Spray Gun</b> 水性LVLP & HVLP 噴槍
51		<b>51</b>	<b>Air Regulator &amp; Gauge</b> 數位壓力錶



Semi-Professional  
Quality 半專業級



Professional  
Quality 專業級



Industrial  
Quality 工業級



# 1/2" Air Impact Wrench

One Hand Operated F/R Switch 氣動衝擊風扳-單手操作

www.airprotool.com

**Hammer Cage Support Design**  
reduce vibration

**One Hand Operated F/R Switch**  
3 Speed F/R

**Torque Control**  
Enhance reverse power for easy fasten screw

**Rotor Rear Suspension Mechanism**  
avoid scratches between rotor & front plate

**Japanese Bakelite Blade**

**Cylinder Material: FCD45**  
resist abrasion

**360 ° Swivel Air Inlet**

**Lightweight Compact Design**  
**High Power Performance**



**SA22091**  
**1/2" Air Impact Wrench**

- Twin Hammer Mechanism

126 mm

**SA22094**  
**1/2" Mini Air Impact Wrench**

- Twin Hammer Mechanism

106 mm

**SA22095**  
**1/2" Mini Air Impact Wrench**

- Jumbo Hammer Mechanism

95 mm

Model No.	Square Drive	Air Cons		Max Torque		Free Speed	Air Inlet	Air Pressure		Hose Size	Overall Length		Net Weight	
	四方頭	耗氣量		最大扭力		無負載轉速	進氣口	空氣壓力		氣管	長度		重量	
	Inch	CFM	L/min	ft-lb	N-m	RPM	NPT(PT)	psi	bar	ID	Inch	mm	lb	kg
SA22091	1/2	7	198	500	678	10000	1/4	90	6.3	3/8"	5.0	126	4.0	1.8
SA22094	1/2	7	198	500	678	10000	1/4	90	6.3	3/8"	4.2	106	3.1	1.4
SA22095	1/2	7	198	500	678	10000	1/4	90	6.3	3/8"	3.7	95	3.1	1.4





# 1/2" Air Impact Wrench

## 氣動衝擊風扳

**Hammer Cage Support Design**  
reduce vibration

**Variable - Speed Trigger**  
precise control

**Lightweight Compact Design**  
**High Power Performance**

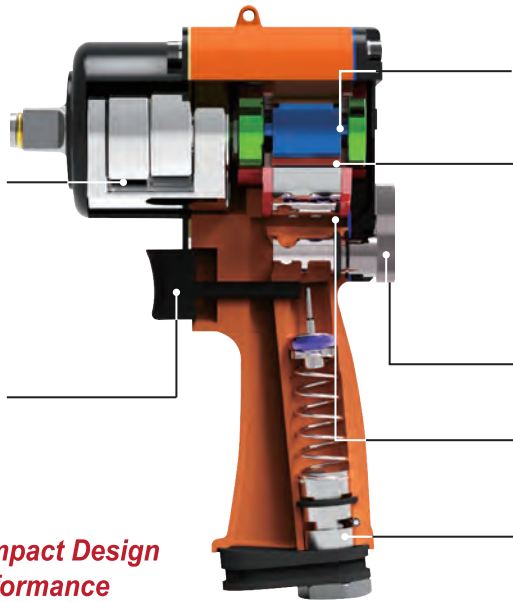

**Rotor Rear Suspension Mechanism**  
avoid scratches between rotor & front plate

**Japanese Bakelite Blade**

**F/R Switch**  
3 Speed F/R

**Torque Control**  
Enhance reverse power for easy fasten screw

**Cylinder Material: FCD45**  
resist abrasion

**360 ° Swivel Air Inlet**

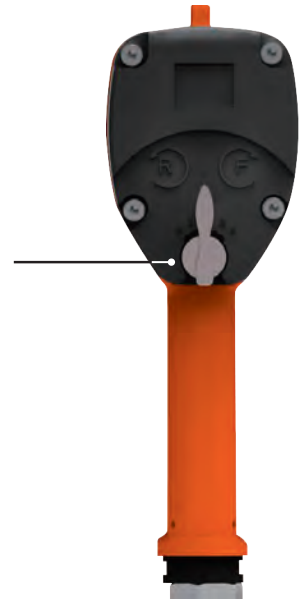

**SA22090**  
**1/2" Air Impact Wrench**

- Twin Hammer Mechanism



**SA22092**  
**1/2" Mini Air Impact Wrench**

- Twin Hammer Mechanism



**SA22093**  
**1/2" Mini Air Impact Wrench**

- Jumbo Hammer Mechanism



Model No.	Square Drive	Air Cons		Max Torque		Free Speed	Air Inlet	Air Pressure		Hose Size	Overall Length		Net Weight	
	四方頭	耗氣量		最大扭力		無負載轉速	進氣口	空氣壓力		氣管	長度		重量	
	Inch	CFM	L/min	ft-lb	N-m	RPM	NPT(PT)	psi	bar	ID	Inch	mm	lb	kg
SA22090	1/2	7	198	500	678	10000	1/4	90	6.3	3/8"	5.0	126	4.0	1.8
SA22092	1/2	7	198	500	678	10000	1/4	90	6.3	3/8"	4.2	106	3.1	1.4
SA22093	1/2	7	198	500	678	10000	1/4	90	6.3	3/8"	3.7	95	3.1	1.4



# Mini Air Impact Wrench

## 3/8" & 1/2" 迷你型氣動衝擊風扳

www.airprotool.com

**SA22068 1/2"**  
**SA21038 3/8"**  
**Square Drive Mini Air Impact Wrench**

- Twin Hammer Mechanism
- Rear exhaust



**SA22066 1/2"**  
**SA21037 3/8"**  
**Square Drive Mini Air Impact Wrench**

- Jumbo Hammer Mechanism
- Rear exhaust



**SA22056**  
**1/2" Super Duty Air Impact Wrench**

- Hyper-Compact Impact Wrench
- Jumbo Hammer Mechanism



**SA22048**  
**1/2" Air Impact Wrench**

- Twin Hammer Mechanism
- Vibration: 3.1m/s<sup>2</sup>
- Bolt Capacity: 16mm



**SA22049**  
**1/2" Air Impact Wrench**

- Twin Hammer Mechanism
- Vibration: 3.1m/s<sup>2</sup>
- Bolt Capacity: 16mm



**SA22050**  
**1/2" Air Impact Wrench**

- Jumbo Hammer Mechanism
- Vibration: 2.8m/s<sup>2</sup>
- Bolt Capacity: 16mm



**SA22061**  
**1/2" Powerful Mini Air Impact Wrench**

- Twin Hammer Mechanism



**SA22059**  
**1/2" Powerful Compact Air Impact Wrench**

- Jumbo Hammer Mechanism



**SA22058**  
**1/2" Powerful Compact Air Impact Wrench**

- Jumbo Hammer Mechanism



Model No.	Square Drive	Air Cons		Max Torque		Free Speed	Air Inlet	Air Pressure		Hose Size	Overall Length		Net Weight	
	四方頭	耗氣量		最大扭力		無負載轉速	進氣口	空氣壓力		氣管	長度		重量	
	Inch	CFM	L/min	ft-lb	N-m	R.P.M	NPT(PT)	psi	bar	ID	Inch	mm	lb	kg
SA22048	1/2	7	198	500	678	11000	1/4"	90	6.3	3/8"	4.25	108	3.1	1.42
SA22049	1/2	7	198	450	610	11000	1/4"	90	6.3	3/8"	4.05	103	3	1.37
SA22050	1/2	7	198	500	678	11000	1/4"	90	6.3	3/8"	3.89	99	3	1.36
SA22061	1/2	18SCFM		500	678	10000	1/4"	90	6.3	1/2"	4.29	109	3	1.4
SA22059	1/2	18SCFM		550	745	9000	1/4"	90	6.3	1/2"	4.29	109	3.3	1.5
SA22058	1/2	18SCFM		500	678	10000	1/4"	90	6.3	1/2"	3.89	99	3	1.35
SA22068/SA21038	1/2, 3/8	4.8	135.9	500	678	10000	1/4"	90	6.3	3/8"	3.85	98	3	1.35
SA22066/SA21037	1/2, 3/8	4.8	135.9	500	678	9500	1/4"	90	6.3	3/8"	3.66	93	2.9	1.33
SA22056	1/2	4.7	133	500	678	9500	1/4"	90	6.3	3/8"	3.81	97	3.6	1.65





# (Mini) Composite Air Impact Wrench

## 1/2" (迷你型) 塑膠氣動衝擊風扳

### SA22084 1/2" Composite Air Impact Wrench



- Twin Hammer Mechanism
- One Hand F/R Switch



### SA22065 1/2" Composite Mini Air Impact Wrench

- Twin Hammer Mechanism
- Forward: 3 Speeds
- Reverse: 3 Speeds
- One Hand F/R Switch



### SA22079 1/2" Composite Stubby Air Impact Wrench

- Jumbo Hammer Mechanism
- One Hand F/R Switch
- 3 Speeds setting in Forward
- Full power in Reverse



### SA22080 1/2" Composite Stubby Air Impact Wrench

- Twin Hammer Mechanism
- One Hand F/R Switch
- 3 Speeds setting in Forward
- Full power in Reverse



### SA22064PW 1/2" Stubby Composite Air Impact Wrench

- Twin Hammer Mechanism
- Handle exhaust
- Forward: 3 Speeds
- Reverse: 1 Speeds



### SA22072P 1/2" Composite Air Impact Wrench

- Twin Hammer Mechanism
- One Hand F/R Switch
- Handle exhaust



Model No.	Square Drive	Air Cons		Max Torque		Free Speed	Air Inlet	Air Pressure		Hose Size	Overall Length		Net Weight		Bolt Capacity
	四方頭	耗氣量		最大扭力		無負載轉速	進氣口	空氣壓力		氣管	長度		重量		螺栓能力
	Inch	CFM	L/min	ft-lb	N-m	R.P.M	NPT(PT)	psi	bar	ID	Inch	mm	lb	kg	mm
SA22084	1/2	4	113	350	472	7000	1/4"	90	6.3	3/8"	5.7	144	3.3	1.5	16
SA22065	1/2	4	113	450	600	10000	1/4"	90	6.3	3/8"	4.9	125	2.8	1.3	19
SA22079	1/2	32SCFM		550	745	10000	1/4"	90	6.3	1/4"	5.1	130	3.3	1.5	16
SA22080	1/2	32SCFM		500	675	10000	1/4"	90	6.3	1/4"	5.3	134	3.3	1.5	16
SA22072P	1/2	40SCFM		800	1085	7500	1/4"	90	6.3	3/8"	7.2	184	5.2	2.35	22
SA22064PW	1/2	4.37	123.7	550	745	7000	1/4"	90	6.3	3/8"	5.8	148	3.5	1.6	16



# Composite Air Impact Wrench

## 3/8", 1/2" & 1" 塑膠氣動衝擊風扳

www.airprotool.com

### SA21039P 3/8" Composite Air Impact Wrench

- Jumbo Hammer Mechanism
- One Hand F/R Switch



### SA22074P 1/2" Composite Air Impact Wrench

- Jumbo Hammer Mechanism
- One Hand F/R Switch



### SA22075P 1/2" Composite Air Impact Wrench

- Jumbo Hammer Mechanism
- One Hand F/R Switch



### SA22069P 1/2" Super Duty Composite Air Impact Wrench

- Twin Hammer Mechanism



### SA21040P 3/8" SA22088P 1/2" 1/2" Mini Composite Air Impact Wrench

- Twin Hammer Mechanism
- Handle Exhaust



### SA22089P 1/2" Composite Air Impact Wrench

- Twin Hammer Mechanism
- Handle Exhaust



### SA22168P-TL 1/2" Torque Limit Composite Air Impact Wrench

- Twin Hammer Mechanism



### SA2499 1" Super Duty Composite Air Impact Wrench w/ 2" Anvil

- Also available w/6" /8" extended anvil model SA2499-6/SA2499-8
- Side Exhaust
- Twin Hammer Mechanism



### SA2493 1" Super Duty Composite Air Impact Wrench w/ 2" Anvil

- Also available w/6" /8" extended anvil model SA2493-6/SA2493-8
- Side Exhaust
- Twin Hammer Mechanism



Model No.	Square Drive	Air Cons		Max Torque		Free Speed	Air Inlet	Air Pressure		Hose Size	Overall Length		Net Weight	
	四方頭	耗氣量		最大扭力		無負載轉速	進氣口	空氣壓力		氣管	長度		重量	
	Inch	CFM	L/min	ft-lb	N-m	R.P.M	NPT(PT)	psi	bar	ID	Inch	mm	lb	kg
SA21039P	3/8	4.8	136	450	610	10500	1/4"	90	6.3	3/8"	5.9	150	2.8	1.3
SA22074P	1/2	4.7	133	500	678	9500	1/4"	90	6.3	3/8"	4.4	112	2.6	1.16
SA22075P	1/2	5.4	153	800	1085	7300	1/4"	90	6.3	3/8"	6.9	175	4.4	2.0
SA22069P	1/2	7.3	207	1000	1356	9500	1/4"	90	6.3	3/8"	7.5	191	5.1	2.3
SA21040P	3/8	3.7	104.8	330	448	10000	1/4"	90	6.3	3/8"	6.7	170	3.0	1.35
SA22088P	1/2	3.7	104.8	420	570	10000	1/4"	90	6.3	3/8"	6.7	170	3.1	1.4
SA22089P	1/2	5.46	154.6	580	786	9000	1/4"	90	6.3	3/8"	7.7	195	4.3	1.95
SA22168P-TL	1/2	4.9	138.7	1000	1350	8500	1/4"	90	6.3	3/8"	7.7	195	4.8	2.2
SA2499	1	47SCFM		1800	2440	4500	1/2"	90-115	6.3-8	1/2"	17.3	440	13.4	6.1
SA2493	1	47SCFM		2000	2712	4500	1/2"	90	6.3	1/2"	18.4	470	17.3	7.8





# Air Impact Wrench

## 1/2", 3/4" & 1" 氣動衝擊風扳

**SA22043**  
1/2" Air Impact Wrench

- Twin Hammer Mechanism
- Vibration: 2.8 m/sec<sup>2</sup>



**SA22060**  
1/2" Powerful Mini Air Impact Wrench

- Twin Hammer Mechanism



**SA22046**  
1/2" Air Impact Wrench

- Twin Hammer Mechanism



**SA22083**  
1/2" Industrial Air Impact Wrench

- Twin Hammer Mechanism
- Forward: 3 Speeds
- Reverse: 1 Speeds



**SA22085**  
1/2" Pro. Economic Air Impact Wrench

- Twin Hammer Mechanism
- Forward: 3 Speeds
- Reverse: 1 Speeds



**SA2385**  
3/4" Air Impact Wrench

- Twin Hammer Mechanism



**SA2387**  
3/4" Air Impact Wrench

- Also available w/6" extended anvil, model SA2387-6
- Twin Hammer Mechanism
- Vibration: 6.1/sec<sup>2</sup>



**SA2491**  
1" Air Impact Wrench

- Also available w/6" extended anvil, model SA2491-6
- Twin Hammer Mechanism
- Vibration: 6.1/sec<sup>2</sup>



**SA24100**  
1" Air Impact Wrench

- Twin Hammer Mechanism
- Forward: 3 Speeds
- Reverse: 1 Speeds
- Top exhaust



Model No.	Square Drive	Air Cons		Max Torque		Free Speed	Air Inlet	Air Pressure		Hose Size	Overall Length		Net Weight		Bolt Capacity
	四方頭	耗氣量		最大扭力		無負載轉速	進氣口	空氣壓力		氣管	長度		重量		螺栓能力
	Inch	CFM	L/min	ft-lb	N-m	R.P.M	NPT(PT)	psi	bar	ID	Inch	mm	lb	kg	mm
SA22043	1/2	5.8	164.2	500	678	10000	1/4"	90	6.3	3/8"	4.8	122	3.3	1.5	14
SA22060	1/2	18SCFM		550	745	10000	1/4"	90	6.3	1/2"	4.7	120	3.5	1.6	23
SA22046	1/2	5.8	164.2	1000	1350	7500	1/4"	90	6.3	3/8"	6.4	165	5.5	2.5	32
SA2385	3/4	5.8	164.2	1000	1350	7500	1/4"	90	6.3	3/8"	6.7	170	5.5	2.5	34
SA22085	1/2	5.0	141.6	650	878	9000	1/4"	90	6.3	3/8"	8.0	203	5.5	2.5	23
SA22083	1/2	4.7	133.1	670	881	9200	1/4"	90	6.3	3/8"	6.4	165	5.3	2.4	23
SA2387	3/4	11.3	320	1400	1898	4500	3/8"	90	6.3	3/8"	8.5	215	11	5	38
SA2491	1	11.3	320	1500	2033	4500	3/8"	90	6.3	3/8"	8.7	222	11.2	5.1	38
SA24100	1	4.8	136	1800	2440	5200	1/2"	90	6.3	1/2"	10.24	260	16.3	7.4	35



# Air Impact Wrench

## 1" & 1-1/2" 氣動衝擊風扳

www.airprotool.com

### SA2424 1" Heavy Duty Air Impact Wrench

- Pinless Mechanism
- Side exhaust
- F/R: 4 Speeds



### SA2480-P 1" Super Duty Air Impact Wrench

- Also available w/6" extended anvil, model SA2480-P-6
- Pinless Mechanism
- Front exhaust



### SA24102-6 1" Super Duty Air Impact Wrench w/ 6" Anvil

- Also available standard anvil, model SA24102
- Pinless Mechanism



### SA2492-6 1" Super Duty Air Impact Wrench

- Ultra Lightweight Series
- Also available standard anvil, model SA2492
- Twin Hammer Mechanism



### SA2456 Outside Trigger SA2457 Inside Trigger 1" Heavy Duty Air Impact Wrench

- Twin Hammer Mechanism
- Also available w/6", 8" extended anvil, model SA2456B(C)/SA2457B(C)
- Side exhaust



### SA2457#5 1/2" SA2457B#5 6" #5 Heavy Duty Air Impact Wrench

- Twin Hammer Mechanism
- Side exhaust



### SA2505 ★★★★★ 1-1/2" Air Impact Wrench

- Also available w/8" extended anvil, model SA2505-8
- Twin Hammer Mechanism
- Side exhaust



### SA2504 ★★★★★ 1-1/2" Air Impact Wrench

- Twin Hammer Mechanism
- F/R: 4 Speeds
- Top exhaust



### SA2458 Outside Trigger ★★★★★ SA2459 Inside Trigger 1-1/2" Heavy Duty Air Impact Wrench

- Twin Hammer Mechanism
- Also available w/6" extended anvil, model SA2458-6/SA2459-6
- Side exhaust



Model No.	Square Drive	Air Cons		Max Torque		Free Speed	Air Inlet	Air Pressure		Hose Size	Overall Length		Net Weight		Bolt Capacity
	四方頭	耗氣量		最大扭力		無負載轉速	進氣口	空氣壓力		氣管	長度		重量		螺栓能力
	Inch	CFM	L/min	ft-lb	N-m	R.P.M	NPT(PT)	psi	bar	ID	Inch	mm	lb	kg	mm
SA2424	1	6.8	192.5	2200	2983	3400	3/8"	90	6.3	1/2"	12.0	306	27.3	12.4	45
SA2480-P	1	7.7	218	1600	2170	4000	1/2"	90	6.3	3/4"	10.8	275	24.5	11.1	-
SA24102-6	1	9.1	258	2500	3390	4500	1/2"	90	6.3	3/4"	21.1	535	30.0	13.6	-
SA2492-6	1	9	255	2000	2712	5000	1/2"	90	6.3	3/4"	19.2	487	17.9	8.1	36
SA2456(57)	1	16	452	2130	2900	2800	3/8"	90	6.3	1/2"	15.5	393	22.7	10.3	30
SA2457#5	#5	16	452	2130	2900	2800	3/8"	90	6.3	1/2"	15.5	393	25.4	11.5	27
SA2457B#5	#5	16	452	2060	2800	2800	3/8"	90	6.3	1/2"	21.4	543	28.1	12.7	27
SA2458(59)	1-1/2	16	452	2210	3000	2800	3/8"	90	6.3	1/2"	16.5	418	25.4	11.5	30
SA2504	1-1/2	7	198.1	3000	4068	3700	1/2"	90	6.3	1/2"	19.3	490	33.5	15.2	44
SA2505	1-1/2	80 SCFM		4000	5420	3000	1/2"	90-115	6.3-8	3/4"	17.7	450	37.5	17	85



# (Mini Composite) Air Impact Wrench Kit

## 1/2" & 3/4" (迷你型塑膠)氣動衝擊風扳

### SA22043K1 1/2" Impact Wrench Kit

Contents	
1PC	SA22043
1PC	5" Extension Bar
1PC	Oil Pot
1PC	Nipple
1PC	Mini Oiler
1PC	Hex Wrench
10PCS	Sockets 9,10,11,13,14,17,19,22,24,27mm
1PC	Blow Molded Case



### SA22046K 1/2" Impact Wrench Kit

Contents	
1PC	SA22046
1PC	5" Extension Bar
1PC	Oil Pot
1PC	Nipple
1PC	Mini Oiler
1PC	Hex Wrench
10PCS	Sockets 9,10,11,13,14,17,19,22,24,27mm
1PC	Blow Molded Case



### SA2385K 3/4" Air Impact Wrench Kit

Contents	
1PC	SA2385
1PC	Oil Pot
1PC	Nipple
1PC	Mini Oiler
1PC	Hex Wrench
8PCS	Sockets 26,27,29,30,32,35,36,38mm
1PC	Blow Molded Case



### SA22002PK Mini 1/2" Composite Air Impact Wrench Kit

Contents	
1PC	SA22002P
1PC	5" Extension Bar
1PC	Oil Pot
1PC	Nipple
1PC	Mini Oiler
1PC	Star Hex Wrench
10PCS	Sockets 9,10,11,13,14,17,19,22,24,27mm
1PC	Blow Molded Case



### SA22168PK 1/2" Composite Air Impact Wrench Kit

Contents	
1PC	SA22168P
1PC	5" Extension Bar
1PC	Oil Pot
1PC	Nipple
1PC	Mini Oiler
1PC	Star Hex Wrench
10PCS	Sockets 9,10,11,13,14,17,19,22,24,27mm
1PC	Blow Molded Case



### SA22168PTK 1/2" Composite Air Impact Wrench Kit

Contents	
1PC	SA22168PT
1PC	5" Extension Bar
1PC	Oil Pot
1PC	Nipple
1PC	Mini Oiler
1PC	Star Hex Wrench
10PCS	Sockets 9,10,11,13,14,17,19,22,24,27mm
1PC	Blow Molded Case



### SA23168PK 3/4" Composite Air Impact Wrench Kit

Contents	
1PC	SA23168P
1PC	Oil Pot
1PC	Nipple
1PC	Mini Oiler
1PC	Star Hex Wrench
8PCS	Sockets 26,27,29,30,32,35,36,38mm
1PC	Blow Molded Case



### SA23169PK 3/4" Composite Air Impact Wrench Kit

Contents	
1PC	SA23169P
1PC	Oil Pot
1PC	Nipple
1PC	Mini Oiler
1PC	Star Hex Wrench
8PCS	Sockets 26,27,29,30,32,35,36,38mm
1PC	Blow Molded Case







# (Mini) Composite Air Impact Wrench Kit

1/2" & 3/4" One Hand Operated F/R Switch (迷你) 塑膠氣動衝擊風扳

## SA22032PWK

### Mini 1/2" Composite Air Impact Wrench Kit

Contents	
1PC	SA22032PW
1PC	5" Extension Bar
1PC	Oil Pot
1PC	Nipple
1PC	Mini Oiler
1PC	Star Hex Wrench
10PCS	Sockets 9,10,11,13,14,17,19,22,24,27mm
1PC	Blow Molded Case



## SA22033PWK

### 1/2" Composite Air Impact Wrench Kit

Contents	
1PC	SA22033PW
1PC	5" Extension Bar
1PC	Oil Pot
1PC	Nipple
1PC	Mini Oiler
1PC	Star Hex Wrench
10PCS	Sockets 9,10,11,13,14,17,19,22,24,27mm
1PC	Blow Molded Case



## SA22031PWK

### 1/2" Composite Air Impact Wrench Kit

Contents	
1PC	SA22031PW
1PC	5" Extension Bar
1PC	Oil Pot
1PC	Nipple
1PC	Mini Oiler
1PC	Star Hex Wrench
10PCS	Sockets 9,10,11,13,14,17,19,22,24,27mm
1PC	Blow Molded Case



## SA2377PWK

### 3/4" Composite Air Impact Wrench Kit

Contents	
1PC	SA2377PW
1PC	Oil Pot
1PC	Nipple
1PC	Mini Oiler
1PC	Star Hex Wrench
8PCS	Sockets 26,27,29,30,32,35,36,38mm
1PC	Blow Molded Case



## SA22032PWK2

### 1/2" Composite Air Impact Wrench Kit

Contents	
1PC	SA22032PW
1PC	Oil Pot
1PC	Nipple
1PC	75mm Extension Bar
3PCS	Thin Wall Impact Socket 17,19,21mm
9PCS	Sockets (CR-V) 13,14,15,16,17,18,19,21,24mm
1PC	Blow Molded Case



## SA22064PWK

### 1/2" Composite Air Impact Wrench Kit

Contents	
1PC	SA22064PW
1PC	Oil Pot
1PC	Nipple
1PC	75mm Extension Bar
3PCS	Thin Wall Impact Socket 17,19,21mm
9PCS	Sockets (CR-V) 13,14,15,16,17,18,19,21,24mm
1PC	Blow Molded Case



## SA22032PWK3 / SA22064PWK2

### 1/2" Composite Air Impact Wrench Kit

Contents	
1PC	SA22032PW/SA22064PW
1PC	Oil Pot
1PC	Nipple
1PC	75mm Extension Bar
3PCS	Thin Wall Impact Socket 17,19,21mm
1PC	Blow Molded Case



## SA22031PWK2 / SA22033PWK2

### 1/2" Composite Air Impact Wrench Kit

Contents	
1PC	SA22031PW/SA22033PW
1PC	Oil Pot
1PC	Nipple
1PC	4mm Hex Wrench
1PC	Mini Oiler
6PCS	Air Deep Socket 17,19,21mm w/Plastic Sleeves/22,23,24mm
1PC	Blow Molded Case





# Air Ratchet Wrench

## 3/8" & 1/2" 氣動棘輪扳手

SA3707-10 / SA3707-11  
SA3707-12 / SA3707-13  
SA3707-14 / SA3707-15  
SA3707-17 / SA3707-19

### Air Ratchet Wrench

- Side exhaust

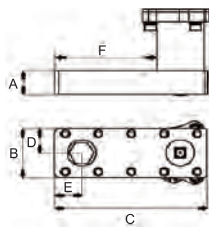

Model	A mm	B mm	C mm	D mm	E mm	F mm
SA3707	22	45	131	22.5	23	87

SA3709-15  
SA3709-16  
SA3709-17  
SA3709-18  
SA3709-19  
SA3709-11/16

### Go-Through Air Ratchet Wrench

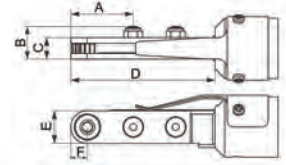

Model	A mm	B mm	C mm	D mm	E mm	F mm
SA3709	51	26	18	115	33.2	16.6

SA3005 3/8"  
SA3006 1/2"

### Air Ratchet Wrench

- Rear exhaust



SA3530 3/8"  
SA3531 1/2"

### Super Duty Air Impact Composite Ratchet Wrench

- Unicorn Hammer Mechanism



SA3057 1/4"  
SA3144 3/8"

### Super Duty Air Impact Composite Ratchet Wrench

- Unicorn Hammer Mechanism



SA3533  
SA3533-3/8

### None Counterforce Air Ratchet Wrench

- Pin Clutch Mechanism  
- Rear exhaust



SA3131 3/8"  
SA3218 1/2"

### Air Impact Ratchet Wrench

- Capacity Bolt: 10mm  
- Sug Air Comp.: 2HP



SA3132 3/8"  
SA3217 1/2"

### 70° Snake Head Ratchet Wrench

- Capacity Bolt: 10mm  
- Sug Air Comp.: 2HP



### SA3605K 17PCS Thru-Hole Air Ratchet Kit

Contents	
1PC	SA3605 Thru-Hole Air Ratchet
12PCS	3/4" Hex Drive Thru-Hole Socket: 8,9,10,11,12,13,14,15,16,17,18,19mm
2PCS	3/8" & 1/2" Adaptor
1PC	3" Thru-Hole Extension Bar
1PC	Blow Molded Case



### SA3606K 17PCS Thru-Hole Air Ratchet Kit

Contents	
1PC	SA3606 Thru-Hole Air Ratchet
12PCS	3/4" Hex Drive Thru-Hole Socket: 8,9,10,11,12,13,14,15,16,17,18,19mm
2PCS	3/8" & 1/2" Adaptor
1PC	3" Thru-Hole Extension Bar
1PC	Blow Molded Case



Model No.	Square Drive	Air Cons		Max Torque		Free Speed	Air Inlet	Air Pressure		Hose Size	Overall Length		Net Weight	
	四方頭	耗氣量		最大扭力		無負載轉速	進氣口	空氣壓力		氣管	長度		重量	
	Inch	CFM	L/min	ft-lb	N-m	R.P.M	NPT(PT)	psi	bar	ID	Inch	mm	lb	kg
SA3707	Hex:10-19mm	7	198.1	135	180	7000	1/4"	90	6.3	3/8"	7.0	177	4.9	2.2
SA3709	Hex:15-19 mm,11/16"	12.5	353.9	66	90	150	1/4"	90	6.3	3/8"	15.3	388	5.3	2.4
SA3533(-3/8)	3/8,1/2	8.8	250	89	120	200	1/4"	90	6.3	3/8"	12.8	327	4.0	1.8
SA3005/SA3006	3/8,1/2	4	113	50	68	500	1/4"	90	6.3	3/8"	10.4	265	2.9	1.3
SA3530/SA3531	3/8,1/2	4	113	100	136	600	1/4"	90	6.3	3/8"	11.9	301	4.0	1.8
SA3057	1/4	3.1	88	50	68	700	1/4"	90	6.3	3/8"	6.5	164	1.3	0.6
SA3144	3/8	3.1	88	50	68	700	1/4"	90	6.3	3/8"	6.5	164	1.3	0.6
SA3131(SA3218)	3/8,1/2	7	198.1	50	68	400	1/4"	90	6.3	3/8"	11.6	295	2.9	1.3
SA3132(SA3217)	3/8,1/2	9.5	269	45	61	160	1/4"	90	6.3	3/8"	11.6	295	2.9	1.3
SA3605	-	7.1	200	81.5	110	160	1/4"	90	6.3	3/8"	10.6	270	2.6	1.2
SA3606	-	8.8	250	89	120	200	1/4"	90	6.3	3/8"	12.8	325	2.6	1.2



# Air Sander

## 氣動砂光機

www.airprotool.com

SA4962 2"  
SA4962-3 3"

**Industrial Orbital  
Angle Sander (Lever-Type)**

- Swivel Side exhaust



SA4981 2"  
SA4981-3 3"

**Industrial Angle Sander (Lever-Type)**

- Swivel Side exhaust



SA4982 2"  
SA4982-3 3"

**Industrial Angle Sander (Lever-Type)**

- Swivel Side exhaust



SA4962KN 2"  
SA4962KN-3 3"

**Industrial Orbital  
Angle Sander (Knob-Type)**

- Swivel Side exhaust



SA4981KN 2"  
SA4981KN-3 3"

**Industrial Angle Sander (Knob-Type)**

- Swivel Side exhaust



SA4982KN 2"  
SA4982KN-3 3"

**Industrial Angle Sander (Lever-Type)**

- Swivel Side exhaust



SA4108  
**Mini Angle Sander**

- Orbit Dia: 0.75mm



SA4711  
**Mini Angle Sander**

- Orbit Dia: 3mm



SA4712  
**Mini Angle Sander**



Model No.	Pad Size	Free Speed	Net Weight		Air Cons	Air Inlet	Air Pressure		Overall Length	
	底盤尺寸	無負載轉速	重量		耗氣量	進氣口	空氣壓力		長度	
	Inch	R.P.M	lb	kg	SCFM	NPT(PT)	psi	bar	Inch	mm
SA4962(-3)	2 / 3	16000	1.3	0.6	22	1/4"	90	6.3	4.6	117
SA4962KN(-3)	2 / 3	16000	1.3	0.6	22	1/4"	90	6.3	4.1	105
SA4981(-3)	2 / 3	16000	1.1	0.5	22	1/4"	90	6.3	3.7	95
SA4981KN(-3)	2 / 3	16000	1.1	0.5	22	1/4"	90	6.3	3.3	83
SA4982(-3)	2 / 3	19000	1.1	0.5	22	1/4"	90	6.3	3.7	95
SA4982KN(-3)	2 / 3	19000	1.1	0.5	22	1/4"	90	6.3	3.3	83
SA4108	1.25	18000	0.8	0.36	240 L/min	1/4"	85	5.9	6.0	153
SA4711	-	16000	0.97	0.44	240 L/min	1/4"	85	5.9	6.0	153
SA4712	1.18	10000	1.15	0.52	360 L/min	1/4"	85	5.9	7.1	180





# Air Sander

## 氣動砂光機

**SA4951S w/ Hook Face Pad**  
**6" Self-Generated Vacuum**  
**Dust Free D/A Sander**

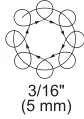

**SA4952N**  
**6" Non-Vacuum D/A Sander**

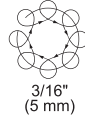

**SA4953C**  
**6" Central-Vacuum D/A Sander**

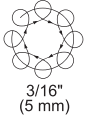

**SA4956S w/5" Hook Face Pad**  
**SA4956S-6H w/6" Hook Face Pad**  
**Self-Generated Vacuum**  
**Dust Free D/A Sander**



**SA4954N w/5" Hook Face Pad**  
**SA4954N-6H w/6" Hook Face Pad**  
**Non-Vacuum D/A Sander**



**SA4955C w/5" Hook Face Pad**  
**SA4955C-6H w/6" Hook Face Pad**  
**Central-Vacuum D/A Sander**



**SA4940SF w/ Hook Face Pad**  
**SA4940SF-V w/ Vinyl Face Pad**  
**3"x4" Oil-Free Self-Generated**  
**Vacuum Jitterbug Sander**

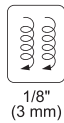

**SA4942N w/ Hook Face Pad**  
**SA4942N-V w/ Vinyl Face Pad**  
**3"x4" Oil-Free Non-Vacuum**  
**Jitterbug Sander**

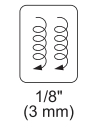

**SA4939CF w/ Hook Face Pad**  
**SA4939CF-V w/ Vinyl Face Pad**  
**3"x4" Oil-Free Central Vacuum**  
**Jitterbug Sander**

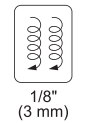

**SA4942S w/ Hook Face Pad**  
**SA4942S-V w/ Vinyl Face Pad**  
**3"x4" Self-Generated Vacuum**  
**Jitterbug Sander**

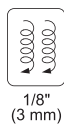

**SA4940N w/ Hook Face Pad**  
**SA4940N-V w/ Vinyl Face Pad**  
**3"x4" Non-Vacuum**  
**Jitterbug Sander**

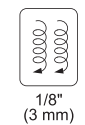

**SA4941C w/ Hook Face Pad**  
**SA4941C-V w/ Vinyl Face Pad**  
**3"x4" Central Vacuum**  
**Jitterbug Sander**

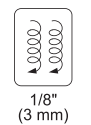

Model No.	Pad Size		Orbit Dia		Free Speed	Vac.Mode	Air Cons		Air Inlet	Air Pressure		Net Weight		Hose Size	
	底盤尺寸		偏擺直徑		無負載轉速	吸塵方式	耗氣量		進氣口	空氣壓力		重量		氣管	
	Inch	Inch	Inch	mm	R.P.M	-	CFM	L/min	NPT(PT)	psi	bar	lb	kg	Inch	mm
SA4951S	6	3/16	5	10000	Self Generated Vac	10.6	300	1/4"	90	6.3	2.2	1	1/4	6.35	
SA4952N	6	3/16	5	10000	Non-Vac	10.6	300	1/4"	90	6.3	2.2	1	1/4	6.35	
SA4953C	6	3/16	5	10000	Central Vac	10.6	300	1/4"	90	6.3	2.2	1	1/4	6.35	
SA4956S(-6H)	5,6	3/16	5	12000	Self Generated Vac	10.6	300	1/4"	90	6.3	2.11	0.96	1/4	6.35	
SA4954N(-6H)	5,6	3/16	5	12000	Non-Vac	10.6	300	1/4"	90	6.3	2.0	0.91	1/4	6.35	
SA4955C(-6H)	5,6	3/16	5	12000	Central Vac	10.6	300	1/4"	90	6.3	2.09	0.95	1/4	6.35	
SA4940SF(-V)	3x4	1/8	3	10000	Self Generated Vac	6	170	1/4"	90	6.3	1.65	0.75	1/4	6.35	
SA4942N(-V)	3x4	1/8	3	10000	Non-Vac	6	170	1/4"	90	6.3	1.54	0.7	1/4	6.35	
SA4939CF(-V)	3x4	1/8	3	10000	Central Vac	6	170	1/4"	90	6.3	1.65	0.75	1/4	6.35	
SA4942S(-V)	3x4	1/8	3	10000	Self Generated Vac	6	170	1/4"	90	6.3	1.76	0.8	1/4	6.35	
SA4940N(-V)	3x4	1/8	3	10000	Non-Vac	6	170	1/4"	90	6.3	1.65	0.75	1/4	6.35	
SA4941C(-V)	3x4	1/8	3	10000	Central Vac	6	170	1/4"	90	6.3	1.76	0.8	1/4	6.35	



# Air Sander

## 氣動砂光機

www.airprotool.com

**SA4947S**  
5" Self-Generated Vacuum  
Dust Free D/A Sander



**SA4948N**  
5" Non-Vacuum D/A Sander



**SA4949S**  
3"x6" Self-Generated Vacuum  
Dust Free Mini Orbital Sander  
w/ Spring Clips Pad



**SA4968C Orbit 2.5mm**  
**SA4969C Orbit 5mm**  
6" Central Vacuum  
Random Orbital Sander

- Low vibration for swirl-free finishes



**SA4717**  
5" Buffers w/Pad w/ o Bonnet



**SA4950N**  
3"x6" Non-Vacuum Mini Orbital  
Sander w/ Spring Clips Pad



**SA4961C**  
3-1/2"x7" Central-Vacuum  
Orbital Sander w/ Hook Face Pad



**SA4963N**  
3-1/2"x7" Non-Vacuum  
Orbital Sander w/ Hook Face Pad



**SA4964S**  
3-1/2"x7" Self-Generated Vacuum  
Orbital Sander w/ Hook Face Pad



Model No.	Pad Size		Orbit Dia		Free Speed	Vac.Mode		Air Cons		Air Inlet		Air Pressure		Net Weight		Hose Size	
	底盤尺寸		偏擺直徑		無負載轉速	吸塵方式		耗氣量		進氣口		空氣壓力		重量		氣管	
	Inch	Inch	Inch	mm	R.P.M	-		CFM	L/min	NPT(PT)	psi	bar	lb	kg	Inch	mm	
SA4947S	5	3/16	5	5	10000	Self Generated Vac		12	340	1/4"	90	6.3	2.64	1.2	1/4	6.35	
SA4948N	5	3/16	5	5	10000	Non-Vac		12	340	1/4"	90	6.3	2.64	1.2	1/4	6.35	
SA4949S	3x6	3/16	5	5	8000	Self Generated Vac		12	340	1/4"	90	6.3	2.64	1.2	1/4	6.35	
SA4968C/SA4969C	6	3/32(3/16)	2.5/(5)	2.5/(5)	11000	Central Vac		1.6	45.3	1/4"	90	6.3	2	0.9	3/8	10	
SA4717	5	-	-	-	2600	Non-Vac		3	85	1/4"	90	6.3	1.5	0.68	3/8	10	
SA4950N	3x6	3/16	5	5	8000	Non-Vac		12	340	1/4"	90	6.3	2.64	1.2	1/4	6.35	
SA4961C	3-1/2X7	3/32	2.5	2.5	9000	Central Vac		10.6	300	1/4"	90	6.3	2.64	1.2	1/4	6.35	
SA4963N	3-1/2X7	3/32	2.5	2.5	9000	Non-Vac		10.6	300	1/4"	90	6.3	2.64	1.2	1/4	6.35	
SA4964S	3-1/2X7	3/32	2.5	2.5	9000	Self Generated Vac		10.6	300	1/4"	90	6.3	2.64	1.2	1/4	6.35	



# Air Sander & Polisher (Kit)

## 氣動砂光機 & 打蠟機(組套)

### SA4936 30mm Composite Detail Sander

- Air Motor : 0.4HP
- Length: 198mm
- Orbit Dia: 1.5mm



### SA4937-32 SA4937-50 3" Composite Angle Long Polisher

- Length: 283mm



### SA4993 2500RPM SA4994 4000RPM 7" Heavy Duty Composite Angle Polisher / Sander

- Air Motor : 1HP
- Length: 345mm



### SA4611 6" Air Angle Sander

- Length: 200mm



### SA4946 2 In 1 3"Air Sander & 1/4" Angle Die Grinder Tool



### SA4985A 2" SA4985B 3" Composite Mini Air Sander

- Air Motor: 0.25HP



### SA4986 3" Composite Straight Sander

- Air Motor: 0.45HP



### SA4934 5" SA4934-6 6" 120° Air Angle D/A Sander

- Max Torque: 36.2 kg/cm
- Air Motor: 2.5HP



### SA4297 190PCS Spot Repair Sander Kit

- Orbit Dia: 5/64"(2mm)



Contents	
1PC	SA4297 Spot Repair Sander
1PC	2" Velcro Pad
1PC	1.2" Velcro Pad
1PC	Triangle Mini Velcro Pad
1PC	Nipple
2PC	1.2"x1 & 2" x1 Wool Pad
2PC	1.2"x1 & 2" x1 Polishing Pad
1PC	Blow Molded Case
60PCS	2"120#,180#,320#,600#,1000#,1500# Sandpapers x 10
60PCS	1.2"120#,180#,320#,600#,1000#,1500# Sandpapers x 10
60PCS	Triangle mini 120#,180#,320#,600#,1000#,1500# Sandpapers x 10

### SA4935 5" 120° High Speed Sander

- Max Torque: 15.3 kg/cm
- Air Motor : 0.82HP



Model No.	Pad Size	Free Speed	Air Cons		Air Inlet	Air Pressure		Net Weight		Hose Size	
	底盤尺寸	無負載轉速	耗氣量		進氣口	空氣壓力		重量		氣管	
	Inch	R.P.M	CFM	L/min	NPT(PT)	psi	bar	lb	kg	Inch	mm
SA4936	1.18	7500	1	28.3	1/4"	90	6.3	1.43	0.65	3/8	10
SA4937-32(50)	3	3200/5000	2.1	59.5	1/4"	90	6.3	2.29	1.04	3/8	10
SA4993(94)	7	2500/4000	3.8	107.6	1/4"	90	6.3	3.90	1.7	3/8	10
SA4935	5	13500	4	113.2	1/4"	90	6.3	2.42	1.10	3/8	10
SA4934(-6)	5,6	9000	4	113.2	1/4"	90	6.3	3.75	1.70	3/8	10
SA4946	3	16000	18SCFM		1/4"	90	6.3	1.50	0.68	3/8	10
SA4985(A)(B)	2,3	4500	3.2	90.6	1/4"	90	6.3	1.03	0.47	3/8	10
SA4986	3	21000	4	113.2	1/4"	90	6.3	1.39	0.63	3/8	10
SA4297	2	13000	2.6	73.6	1/4"	90	6.3	1.10	0.50	3/8	10
SA4611	6	2500	10.6	300	1/4"	90	6.3	2.20	1.00	3/8	10





# Air Sander

## 氣動砂光機

www.airprotool.com

### SA4989 2" Angle Sander

- Air Motor: 0.3HP
- Rear Exhaust



### SA4990 2" Angle Orbital Sander

- Air Motor : 0.3HP
- Rear Exhaust
- Orbit Dia: 1/8"(3mm)



### SA4991 90° Orbital Sander

- Built-In Speed Regulator
- Also available with Grip, model SA4991G



### SA4992 120° Air Angle D/A Sander

- Built-In Speed Regulator
- Also available with Grip, model SA4992G



### SA4839 Finger Sander



### SA4995 40x86mm Finger Sander



### SA4984 Handy Cam High Speed Air Sander

- Orbit Dia: 3mm



### SA4996 2" Mini Air Sander



Model No.	Pad Size	Free Speed	Air Cons		Air Inlet	Air Pressure		Net Weight		Overall Length		Hose Size	
	底盤尺寸	無負載轉速	耗氣量		進氣口	空氣壓力		重量		長度		氣管	
	Inch	R.P.M	CFM	L/min	NPT(PT)	psi	bar	lb	kg	Inch	mm	Inch	mm
SA4989	2	15000	3.5	99.1	1/4"	90	6.3	1.14	0.52	6.5	165	3/8	10
SA4990	2	15000	3.5	99.1	1/4"	90	6.3	1.36	0.62	5.8	147	3/8	10
SA4991	1.18	18000	3.4	96.3	1/4"	90	6.3	1.17	0.53	6.9	175	3/8	10
SA4992	2 / 3	20000	3.3	93.4	1/4"	90	6.3	1.28	0.58	6.3	160	3/8	10
SA4839	22x50 / 17x65	14000	5.0	141.6	1/4"	90	6.3	1.76	0.80	6.0	152	-	-
SA4995	40x86	11000	5.0	141.6	1/4"	90	6.3	1.76	0.80	8.5	215	-	-
SA4984	70x78mm	10000	8.5	240	1/4"	58-73	4-5	1.76	0.80	8.3	210	-	-
SA4996	2	3000	3.0	84.9	1/4"	90	6.3	1.37	0.62	7.2	182	3/8	10



# Air Sander , Polisher & Belt Sander

## 氣動砂光機, 打蠟機 & 砂帶機

SA4534 w/ 10x330mm Arm  
 SA4535 w/ 20x520mm Arm  
 SA4534PUP w/ PU Pully,10x330mm Arm  
**Air Belt Sander**



SA4537 w/ 20x520mm Arm  
 SA4538 w/ 30x540mm Arm  
 SA4539PUP w/ PU Pully,20x520mm Arm  
**Air Belt Sander w/Side Handle**



SA4535K  
 SA4536K  
**Air Belt Sander Kit (Changable Arm)**



Contents	
1PC	SA4535/SA4536
4PCS	Surface Prep Belt 20x520mm&10x330mm(80,100grit) / 13x457mm & 20x330mm(80,100grit)
2PCS	Interchangeable Contact Arms 20x520 & 10x330mm / 13x457mm & 20x330mm

SA4282PK  
**3" Mini Disc Sander Kit**

Contents	
1PC	SA4282P Disc Sander
2PCS	Roll Lock Holder(2"&3")
4PCS	2" & 3"Sander Discs #100
6PCS	2"Surface Prep Discs(Coarse,Med,Fine)x 2
6PCS	3"Surface Prep Discs(Coarse,Med,Fine)x 2
1PC	Spanner
1PC	Nipple
1PC	Blow Mold Case



SA4686PK  
**3" Mini Air Composite Polisher Kit**



Contents	
1PC	SA4686P Polisher
1PC	3"Backing Pad
1PC	3"Buffing Bonnet
2PCS	3"Foam Compounding Pads(White&Yellow)
1PC	Spanner
1PC	Nipple
1PC	Blow Mold Case

SA4685PK  
**3" Mini Disc Sander Kit**

Contents	
1PC	SA4685P Sander
2PCS	2"&3"Backing Pad
30PCS	2"Sandind Paper (#180x10,#320x10,#600x10)
30PCS	3"Sandind Paper (#180x10,#320x10,#600x10)
1PC	Spanner
1PC	Nipple
1PC	Blow Mold Case



Model No.	Belt Size	Horse Power		Free Speed	Air Cons		Air Inlet	Air Pressure		Net Weight		Sound Level	Overall Length	
	砂帶尺寸	馬力		無負載轉速	耗氣量		進氣口	空氣壓力		重量		噪音值	長度	
	mm	HP	W	R.P.M	CFM	L/min	NPT(PT)	psi	bar	lb	kg	dBA	Inch	mm
SA4534(PUP)	10x330	0.5	373	16500	4	113.2	1/4"	90	6.3	1.94	0.88	85	12.83	326
SA4535	20x520	0.5	373	16500	4	113.2	1/4"	90	6.3	1.94	0.88	85	12.83	326
SA4536	13x457	0.5	373	16500	4	113.2	1/4"	90	6.3	1.94	0.88	85	12.83	326
SA4537	20x520	0.5	373	16500	4	113.2	1/4"	90	6.3	2.93	1.33	85	16.02	407
SA4538	30x540	0.8	597	13000	4	113.2	1/4"	90	6.3	3.31	1.50	85	16.34	415
SA4539PUP	20x520	0.5	373	16500	4	113.2	1/4"	90	6.3	2.93	1.33	85	16.02	407

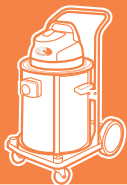

# Professional Vacuum Cleaner

## 吸塵器

www.airprotool.com

### SA-60FA

#### Wet & Dry Separating Vacuum Cleaner (Environmental model)

1. One machine can work with two kinds of motive powers—either air pressure or motor-driven depends on the occasion.
2. Not only can extracting the waste but also separating fluid and dirt at the same time.
3. This product functions include vacuuming dust and metal shaving also extracting oil and CNC cutting Fluid. Dusts and shaved metal waste are sucked out by high-speed motor, which has strong suction.
4. The design of pressure tank discharges by air pressure, repeatedly extract and discharge oil and fluid to clean machines and flush oil grooves.
5. Filter repeatedly leaches impurities of cutting fluid, to ensure the cutting precision and protect cutting tool.



Model No.	Voltage	Consumption Power	Used Pressure	Drum Capacity	Discharge Style	Discharge Hose	Measurement (L x W x H)	Air Inlet
	電壓	消耗功率	壓力	圓筒容量	排出方式	排放管	尺寸	進氣口
	V	W	kg/cm <sup>2</sup>	L	-	-	mm	-
SA-60FA	110	1000	5~7	80	Pressure	Ø 3/4	680×450×1220	1-1/4

### SA-2948TI3

#### 2 Person Mobile Dust Vacuum System w/ Power Hanger w/ o Sander

Contents
1PC Y-join Set & Automatic unit for Pneumatic tools
2PCS 2 in 1 Hose for Pneumatic tools(5M)
1PC 124 Paper bag(830x350mm)
3PCS Pad Hook
2PCS Hose Hanger
1PC Air Blowers
1PC PU Hose
1PC Power Hanger



### SA-3024TI3

#### 1 Person Mobile Dust Vacuum System w/ Power Hanger w/ o Sander

Contents
1PC Automatic unit for Pneumatic tools-Single Hose use only
1PC 2 in 1 Hose for Pneumatic tools(5M)
1PC 3024 Paper bag(520x300mm)
3PCS Pad Hook
2PCS Hose Hanger
1PC Air Blowers
1PC PU Hose
1PC Power Hanger



### SA-3040CEA-B

#### 1 Person Mobile Dust Vacuum System w/ Hose Basket w/ o Sanders for Air Sander & Electric Sander Application

Contents
1PC Automatic unit for Pneumatic tools-Single Hose use only
1PC 2 in 1 Hose for Pneumatic tools(5M)
1PC 124 Paper bag(830x350mm)
1PC Basket



Model No.	Voltage	Consumption Power	Max Vacuum	Air Flow	Drum Capacity	Drum Material	Measurement (L x W x H)	Net Weight
	電壓	消耗功率	最大真空度	空氣流量	圓筒容量	圓筒材質	尺寸	重量
	V	W	mmH <sub>2</sub> O	m <sup>3</sup> /min	L	-	mm	kgs
SA2948TI3		2200	2700	5.6	48			32
SA3024TI3	110V,220V 230V,240V	1100	2200	2.6	24	Stainless	562x500x810(mm)	22
SA-3040CEA-B		1100	2200	2.6	40			20.5



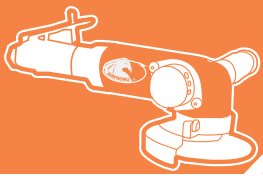

# Air Micro Die Grinder & Air (Angle) Grinder

## 筆型刻磨機 & (彎頭)研磨機

SA50010 1/8"  
SA50010M 3mm  
Industrial Micro Die Grinder w/ Grip

- Rear exhaust



SA5043 1/8",65000RPM  
SA5043M 3mm,65000RPM  
SA50011 1/8",70000RPM  
SA50011M 3mm,70000RPM  
Industrial Micro Die Grinder w/ Grip



SA5043NS 1/8",65000RPM  
SA5043NSM 3mm,65000RPM  
SA50011NS 1/8",70000RPM  
SA50011NSM 3mm,70000RPM  
Industrial Micro Die Grinder w/ o Grip



SA5289  
Turbo Micro Die Grinder



SA5419 1/4" Alum. Housing  
SA5419M 6mm Alum. Housing  
SA5414 1/4" Steel Housing  
SA5414M 6mm Steel Housing  
Heavy Duty Die Grinder w/ Governor

- Rear exhaust



SA5631A 1/8"  
SA5631B 3mm  
SA5631C 1/4"  
SA5631D 6mm  
Low Noise Heavy Duty  
Straight Die Grinder

- Rear exhaust  
- Power: 0.35HP  
- Quick Change Design



SA5720 1/4"  
SA5720M 6mm  
Air Die Grinder

- Power: 0.25HP



SA5624 1/4"  
SA5624M 6mm  
Air Die Grinder



SA5629A 1/8"  
SA5629B 3mm  
SA5629C 1/4"  
SA5629D 6mm  
Low Noise Heavy Duty 90°  
Air Angle Die Grinder

- Rear exhaust  
- Power: 0.35HP  
- Quick Change Design



Model No.	Collet Size		Free Speed	Net Weight		Overall Length		Air Inlet	Air Pressure		Air Cons	
	夾頭尺寸		無負載轉速	重量		長度		進氣口	空氣壓力		耗氣量	
	Inch	mm	R.P.M	lb	kg	Inch	mm	NPT(PT)	psi	bar	CFM	l/min
SA50010(M)	1/8	3	60000	0.3	0.14	5.3	135	1/4"	90	6.3	5.5	156
SA5043(M)(NS)(NSM)	1/8	3	65000	0.3	0.14	5.55	141	1/4"	90	6.3	5.5	156
SA50011(M)(NS)(NSM)	1/8	3	70000	0.28	0.13	5.55	141	1/4"	90	6.3	5.5	156
SA5289	1/8	3	80000	0.4	0.18	5.6	142	1/4"	75	5.2	4.2	119
SA5414(M)	1/4	6	20000	2.86	1.3	8.7	220	3/8"	90	6.3	3.9	110.4
SA5419(M)	1/4	6	20000	1.76	0.8	8.7	220	3/8"	90	6.3	3.9	110.4
SA5631(A)(B)	1/8	3	25000	1.1	0.5	7.0	178	1/4"	90	6.3	20 SCFM	
SA5631(C)(D)	1/4	6	25000	1.1	0.5	7.0	178	1/4"	90	6.3	20 SCFM	
SA5720(M)	1/4	6	22000	1.3	0.6	7.2	184	1/4"	90	6.3	-	
SA5624(M)	1/4	6	3500	2.09	0.95	8.3	210	1/4"	90	6.3	4	113
SA5629(A)(B)	1/8	3	20000	1.32	0.6	6.7	169	1/4"	90	6.3	17.2 SCFM	
SA5629(C)(D)	1/4	6	20000	1.32	0.6	6.7	169	1/4"	90	6.3	17.2 SCFM	

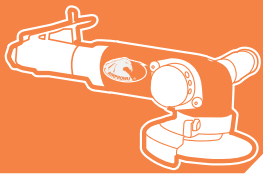

# Industrial Die Grinder

## 工業級研磨機

www.airprotool.com

- SA5278LM 6mm,0.5HP
- SA5278LM-3 3mm,0.5HP
- SA5278L 1/4",0.5HP
- SA5361M 8mm,1HP
- SA5360M 6mm,1HP
- SA5361 3/8",1HP
- SA5360 1/4",1HP

### Industrial Steel Die Grinder (Lever Type)



- SA5278RM 6mm,0.5HP
- SA5278RM-3 3mm,0.5HP
- SA5278R 1/4",0.5HP
- SA5361MS 8mm,1HP

### Industrial Steel Die Grinder (Rotary Throttle Type)



- SA5279LM 6mm,0.5HP
- SA5279LM-3 3mm,0.5HP
- SA5279L 1/4",0.5HP
- SA5359M 8mm,1HP
- SA5358M 6mm,1HP
- SA5359 3/8",1HP
- SA5358 1/4",1HP

### Industrial Extended Steel Die Grinder (Lever Type)



- SA5279RM 6mm,0.5HP
- SA5279RM-3 3mm,0.5HP
- SA5279R 1/4",0.5HP
- SA5358RM 6mm,1HP

### Industrial Extended Steel Die Grinder (Rotary Throttle Type)



- SA5280LM 6mm,0.5HP
- SA5280LM-3 3mm,0.5HP
- SA5280L 1/4",0.5HP
- SA5365M 8mm,1HP
- SA5364M 6mm,1HP
- SA5364 1/4",1HP

### Industrial Extended Steel Die Grinder (Lever Type)



- SA5280RM 6mm,0.5HP
- SA5280RM-3 3mm,0.5HP
- SA5280R 1/4",0.5HP
- SA5363RM 8mm,1HP
- SA5362RM 6mm,1HP
- SA5362R 1/4",1HP

### Industrial Extended Steel Die Grinder (Rotary Throttle Type)



- SA5288LM 6mm,1HP
- SA5288LM-3 3mm,1HP
- SA5288L 1/4",1HP

### Industrial Extended Steel Die Grinder (Lever Type)



- SA5288RM 6mm,1HP
- SA5288RM-3 3mm,1HP
- SA5288R 1/4",1HP

### Industrial Extended Steel Die Grinder (Rotary Throttle Type)



Model No.	Collet Size		Free Speed	Net Weight		Overall Length		Air Inlet	Air Pressure		Horse Power		Air Cons	
	夾頭尺寸			重量		長度			進氣口	空氣壓力		馬力		耗氣量
	Inch	mm	R.P.M	lb	kg	Inch	mm	NPT(PT)		psi	bar	hp	kw	CFM
SA5278L(M)(M-3)	1/4	6,3	22000	2.0	0.9	6.7	169	1/4"	90	6,3	0,5	0,375	5	141,6
SA5278R(M)(M-3)	1/4	6,3	22000	1.8	0.8	6.7	169	1/4"	90	6,3	0,5	0,375	5	141,6
SA5360(M)	1/4	6	22000	2.7	1.2	6.5	166	1/4"	90	6,3	1	0,75	5	141,6
SA5361(M)(MS)	3/8	8	22000	2.7	1.2	6.7	170	1/4"	90	6,3	1	0,75	5	141,6
SA5279L(M)(M-3)	1/4	6,3	20000	2.9	1.3	12.6	319	1/4"	90	6,3	0,5	0,375	3,5	99,1
SA5279R(M)(M-3)	1/4	6,3	20000	2.7	1.2	13.0	330	1/4"	90	6,3	0,5	0,375	3,5	99,1
SA5358/SA5359(M)(RM)	1/4,3/8	6,8	22000	3.6	1.65	12.4	315	1/4"	90	6,3	1	0,75	5	141,6
SA5280L(M)(M-3)	1/4	6,3	20000	3.3	1.5	17.6	446	1/4"	90	6,3	0,5	0,375	3,5	99,1
SA5280R(M)(M-3)	1/4	6,3	20000	3.3	1.5	17.6	446	1/4"	90	6,3	0,5	0,375	3,5	99,1
SA5365M/SA5364(M)	1/4	8,6	20000	6.2	2.8	23.6	600	1/4"	90	6,3	1	0,75	5	141,6
SA5363RM/SA5362R(M)	1/4	8,6	20000	6.2	2.8	23.8	605	1/4"	90	6,3	1	0,75	5	141,6
SA5288L(M)(M-3)	1/4	6,3	20000	10.4	4.7	40.1	1020	1/4"	90	6,3	1	0,75	5	141,6
SA5288R(M)(M-3)	1/4	6,3	20000	10.4	4.7	40.5	1030	1/4"	90	6,3	1	0,75	5	141,6

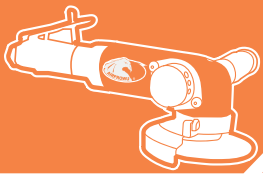

# Industrial Die Grinder

## 工業級研磨機

SA5281LM 6mm ★★★★★  
 SA5281LM-3 3mm  
 SA5281L 1/4"  
**Industrial Angle Steel Die Grinder -Lever Type**

- Power: 0.5HP



SA5282LM 6mm ★★★★★  
 SA5282LM-3 3mm  
 SA5282L 1/4"  
**Industrial 5" Angle Extended Steel Die Grinder -Lever Type**

- Power: 0.5HP



SA5283LM 6mm ★★★★★  
 SA5283LM-3 3mm  
 SA5283L 1/4"  
**Industrial 8" Angle Extended Steel Die Grinder -Lever Type**

- Power: 0.5HP



SA5284L-2 2" ★★★★★  
 SA5284L-3 3"  
**Angle Steel Grinder-Lever Type**

- Power: 0.5HP



SA5284R-2 2" ★★★★★  
 SA5284R-3 3"  
**Angle Steel Grinder - Rotary Throttle Type**

- Power: 0.5HP



SA5285L ★★★★★  
**4" Angle Extended 8" Steel Grinder -Lever Type**

- Power: 0.5HP



SA5625RM 5" ★★★★★  
 SA5626RM 6"  
**Industrial Rotary Type Disc Grinder w/ o Grinding Disc**



SA5721R 1/4" ★★  
 SA5721RM 6mm  
**Industrial Extended Angle Die Grinder-Rotary Throttle Type**

- Round Out 0.15mm



SA5721 1/4" ★★  
 SA5721M 6mm  
**Industrial Extended Angle Die Grinder-Lever Type**

- Round Out 0.15mm



Model No.	Collet/Wheel Size		Free Speed	Net Weight		Overall Length		Air Inlet	Air Pressure		Horse Power		Air Cons	
	夾頭/砂輪尺寸		無負載轉速	重量		長度		進氣口	空氣壓力		馬力		耗氣量	
	Inch	mm	R.P.M	lb	kg	Inch	mm	NPT(PT)	psi	bar	hp	kw	CFM	l/min
SA5281L(M)(M-3)	1/4	6,3	12000	4.2	1.9	10.3	263.5	1/4"	90	6.3	0.5	0.375	5	141.6
SA5282L(M)(M-3)	1/4	6,3	16000	3.7	1.7	14.2	361	1/4"	90	6.3	0.5	0.375	3.5	99.1
SA5283L(M)(M-3)	1/4	6,3	16000	4.4	2.0	19.2	488	1/4"	90	6.3	0.5	0.375	3.5	99.1
SA5284L-2/R-2	2	50	13000	3.1/2.9	1.4/1.3	8.5/8.9	216/227	1/4"	90	6.3	0.5	0.375	3.5	99.1
SA5284L-3/R-3	3	76	13000	3.1/2.9	1.4/1.3	8.5/8.9	216/227	1/4"	90	6.3	0.5	0.375	3.5	99.1
SA5285L	4	100	13000	4.6	2.1	19.2	488	1/4"	90	6.3	0.5	0.375	3.5	99.1
SA5625/SA5626RM	5,6	127/150	7600/6300	5.95/7.7	2.7/3.5	15.9/17.1	405/434	3/8"	90	6.3	1.29/1.39	0.96/1.04	35.3	999.4
SA5721R(M)	1/4	6	15000	3.64	1.65	13.2	335	3/8"	90	6.3	1	0.75	25SCFM	
SA5721(M)	1/4	6	15000	4.4	2.0	15	380	3/8"	90	6.3	1	0.75	25SCFM	



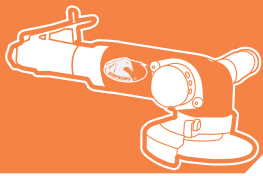

# Air (Angle) Grinder

## 氣動(彎頭)研磨機

www.airprotool.com

**SA5277M Knob-Type**  
**SA5277ML Lever-Type**  
**6mm Industrial Mini**  
**Angle Die Grinder**

- Front exhaust



**SA5643A 1/8"**  
**SA5643B 3mm**  
**SA5643C 1/4"**  
**SA5643D 6mm**  
**Air Die Grinder**



**SA5644A 1/8"**  
**SA5644B 3mm**  
**SA5644C 1/4"**  
**SA5644D 6mm**  
**Air Angle Die Grinder**



**SA5717L Lever Type** ★★☆☆  
**SA5718L Lever Type**  
**SA5719L Lever Type**  
**SA5717R Rotary Throttle Type**  
**SA5718R Rotary Throttle Type**  
**SA5719R Rotary Throttle Type**  
**9" Air Angle Grinder**

-SA5717: M10x1.5P  
 -SA5718: 5/8"-11UNC  
 -SA5719: M14x1.5P



**SA5617**  
**5" Heavy Duty Angle Grinder**  
**w/ Central Vacuum Wheel Guard**



**SA5638 4"**  
**SA5639 4-1/2"**  
**SA5640 5"**  
**Air Angle Grinder**

- Bottom exhaust  
 - SA5638: M10 x 1.5  
 - SA5639: 5/8" -11UNC  
 - SA5640: 5/8" -11UNC



**SA5420A 4"** ★★☆☆  
**SA5420 5"**  
**Air Angle Grinder w/Governor**  
**(Alum. Housing)**

- Rear exhaust



**SA5421A 4"** ★★☆☆  
**SA5421 5"**  
**Air Angle Grinder w/Governor**  
**(Steel Housing)**

- Rear exhaust



**SA5422S Short Shaft** ★★☆☆  
**SA5422L Long Shaft**  
**Abrasive Finishing Tool**  
**w/ Governor, w/ Wheel**



Model No.	Wheel Size		Free Speed	Net Weight		Overall Length		Air Inlet	Air Pressure		Horse Power		Air Cons	
	砂輪尺寸			重量		長度			空氣壓力		馬力		耗氣量	
	Inch	mm	R.P.M	lb	kg	Inch	mm	NPT(PT)	psi	bar	hp	kw	CFM	l/min
SA5277M(L)	Collet: 6mm		20000	0.9	0.4	3.0, 3.5	77, 89	1/4"	90	6.3	0.4	0.3	22SCFM	
SA5643(A)(B)	1/8	3	25000	1.3	0.6	6.1	155	1/4"	90	6.3	0.3	0.2	7.1	200
SA5643(C)(D)	1/4	6	25000	1.3	0.6	6.1	155	1/4"	90	6.3	0.3	0.2	7.1	200
SA5644(A)(B)	1/8	3	15000	1.3	0.6	6.7	170	1/4"	90	6.3	0.3	0.2	7.1	200
SA5644(C)(D)	1/4	6	15000	1.3	0.6	6.7	170	1/4"	90	6.3	0.3	0.2	7.1	200
SA5617	5	125	11000	4	1.8	9.1	232	1/4"	90	6.3	1.3	0.97	4.2	118.9
SA5638(39)(40)	4, 4-1/2, 5	100, 115, 125	11000	2.9	1.3	9.8	250	1/4"	90	6.3	1	0.75	3.6	101.9
SA5717(18)(19)L	9	230	5900	9	4.1	12.2	310	1/4"	90	6.3	2.5	1.9	45	1274.1
SA5717(18)(19)R	9	230	5900	9.5	4.3	11	280	1/4"	90	6.3	2.5	1.9	45	1274.1
SA5420(A)	5, 4	125, 100	12/13000	4.2/3.7	1.9/1.7	10.6	270	3/8"	90	6.3	1	0.75	3.5/4.2	99/119
SA5421(A)	5, 4	125, 100	12/13000	5.1/4.6	2.3/2.1	10.6	270	3/8"	90	6.3	1	0.75	3.5/4.2	99/119
SA5422(S)(L)	-		3200	4.4	2.0	9.6	244	3/8"	90	6.3	1	0.75	30SCFM	

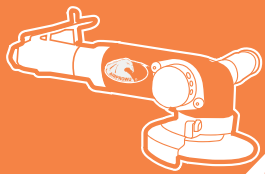

# Air Angle Grinder

## 氣動彎頭研磨機

SA5632 4"  
SA5633 4-1/2"  
SA5634 5"

### 100° Heavy Duty Angle Grinder w/ Swivel Guard

- Swivel Side Exhaust
- SA5632: M10 x 1.5
- SA5633: 5/8" -11UNC
- SA5634: 5/8" -11UNC



SA55001R 4"  
SA55002R 4-1/2"  
SA55003R 5"

### Heavy Duty Angle Grinder w/ Swivel Guard

- Swivel Side Exhaust
- Safety lock-off throttle lever.
- SA5635: M10 x 1.5
- SA5636: 5/8" -11UNC
- SA5637: 5/8" -11UNC



SA5619 ☆☆☆  
SA5619H With Hose  
5" Industrial Air Angle Grinder w/ 360° Swivel Wheel Guard.



SA5705 / SA5705A 3"  
SA5645 / SA5645A 4"  
SA5611 / SA5611A 5"

### 120° Air Angle Grinder

- SA5705A, SA5645A, SA5611A: w/360° Rotatable Wheel Guard.



SA5612  
7" 120° Air Angle Grinder

- Max Torque: 52.3 kg/cm



SA5610  
4" 120° Angle Steel Brush



SA5641  
4" Air Angle Grinder w/ Swivel Guard

- Compact Gear Housing



SA5642  
4" Air Angle Cutter w/ Swivel Guard

- Compact Gear Housing



SA8608  
4" Extended Air Cutter w/ Swivel Guard

- Compact Gear Housing



Model No.	Wheel Size	Free Speed	Net Weight		Overall Length		Air Inlet	Horse Power	Air Cons	
	砂輪尺寸	無負載轉速	重量		長度		進氣口	馬力	耗氣量	
	Inch	R.P.M	lb	kg	Inch	mm	NPT(PT)	HP	CFM	l/min
SA5632	4	10000	3.1	1.4	9.6	244	1/4"	1.2	3.5	99.1
SA5633	4-1/2	11000	3.1	1.4	9.6	244	1/4"	1.2	3.5	99.1
SA5634	5	10000	3.1	1.4	9.6	244	1/4"	1.2	3.5	99.1
SA55001R	4	11000	4	1.8	9.0	230	1/4"	1.3	3.8	107.6
SA55002R	4-1/2	11000	4	1.8	9.0	230	1/4"	1.3	3.8	107.6
SA55003R	5	11000	4	1.8	9.0	230	1/4"	1.3	3.8	107.6
SA5619	5	11500±10%	3.3	1.5	10.4	265	3/8"	1.75	5	141.6
SA5705(A)	3	13500	2.6	1.2	9.8	250	1/4"	0.82	4	113.3
SA5645(A)	4	11000	3.7	1.7	10.2	260	3/8"	1.5	4	113.3
SA5611(A)	5	11000	3.8	1.72	10.2	260	3/8"	1.7	4	113.3
SA5612	7	7000	4.6	2.1	16.5	420	1/4"	3.3	5	141.6
SA5610	4	13500	3.1	1.4	9.8	250	1/4"	0.82	4	113.3
SA5641	4	12000	2.2	1.0	9.0	230	1/4"	1	4.1	116.1
SA5642	4	13000	2.2	1.0	9.0	230	1/4"	1	4.1	116.1
SA8608	4	14000	3.2	1.4	13.6	345	1/4"	1	4.1	116.1



# Air Drill

## 3/8" & 1/2" 氣鑽

www.airprotool.com

SA61023 2100RPM  
SA61034 3000RPM  
3/8" Air Drill (Full Cage Gear)

- Sug. Air Comp: 3HP



SA61024 2100RPM  
SA61030 3000RPM  
3/8" Air Reversible Drill (Full Cage Gear)

- Sug. Air Comp: 3HP



SA61036 350RPM  
SA61037 500RPM  
SA61038 800RPM  
1/2" Air Drill (Full Cage Gear)

- Sug. Air Comp: 3HP



SA61036R 350RPM  
SA61032 500RPM  
SA61033 800RPM  
1/2" Air Reversible Drill (Full Cage Gear)

- Sug. Air Comp: 3HP



★★★★  
SA61046 3500RPM  
3/8" Industrial Heavy Duty Single Direction Air Drill



★★★★  
SA61050 1500RPM  
SA61051 2400RPM  
3/8" Industrial Heavy Duty Reversible Air Drill



★★★★  
SA61047 850RPM  
SA61048 600RPM  
SA61049 300RPM  
1/2" Industrial Heavy Duty Single Direction Air Drill



★★★★  
SA61052 700RPM  
SA61053 410RPM  
SA61054 220RPM  
1/2" Industrial Heavy Duty Reversible Air Drill



Model No.	Chuck Size		Horse Power		Spindle Size	Free Speed	Net Weight		Overall Length		Air Cons		Air Inlet	Hose Size	
	夾頭尺寸		馬力		主軸尺寸	無負載轉速	重量		長度		耗氣量		進氣口	氣管	
	Inch	mm	hp	kw	-	R.P.M	lb	kg	Inch	mm	CFM	l/min	NPT/PT	Inch	mm
SA61023/SA61034	3/8	10	0.7	0.5	3/8"-24	2100/3000	2.71	1.23	7.3	185	10	283	1/4"	3/8	10
SA61024/SA61030	3/8	10	0.7	0.5	3/8"-24	2100/3000	2.73	1.24	7.3	185	10	283	1/4"	3/8	10
SA61036/37/38	1/2	13	0.7	0.5	3/8"-24	350/500/800	3.9	1.77	8.7	220	10	283	1/4"	3/8	10
SA61036R/32/33	1/2	13	0.7	0.5	3/8"-24	350/500/800	3.88	1.76	8.7	220	10	283	1/4"	3/8	10
SA61046	3/8	10	0.8	0.6	3/8"-24	3500	2.65	1.2	6.5	165	5	142	1/4"	3/8	10
SA61050	3/8	10	0.8	0.6	3/8"-24	1500	2.65	1.2	6.5	165	5	142	1/4"	3/8	10
SA61051	3/8	10	0.8	0.6	3/8"-24	2400	2.65	1.2	6.5	165	5	142	1/4"	3/8	10
SA61047	1/2	13	0.8	0.6	1/2"-20	850	3.75	1.7	7.9	200	5	142	1/4"	3/8	10
SA61048	1/2	13	0.8	0.6	1/2"-20	600	3.75	1.7	7.9	200	5	142	1/4"	3/8	10
SA61049	1/2	13	0.8	0.6	1/2"-20	300	3.75	1.7	7.9	200	5	142	1/4"	3/8	10
SA61052	1/2	13	0.8	0.6	1/2"-20	700	3.75	1.7	8.3	210	5	142	1/4"	3/8	10
SA61053	1/2	13	0.8	0.6	1/2"-20	410	3.75	1.7	8.3	210	5	142	1/4"	3/8	10
SA61054	1/2	13	0.8	0.6	1/2"-20	220	3.75	1.7	8.3	210	5	142	1/4"	3/8	10





# Air Drill

1/4" , 5/16" , 3/8" , 1/2" & 5/8" 氣鑽

**SA61026**  
5/16" Air Drill



- Capacity: 8mm
- Max Torque: 3Nm
- Spindle Thread: 3/8"-24



**SA61027**  
1/4" Air Drill



- Capacity: 6mm
- Max Torque: 2.5Nm
- Spindle Thread: 3/8"-24



**SA61084**  
1/4" Air Reversible Drill



- Power: 0.3HP



**SA61074 3/8"**  
**SA61075 1/2"**  
Air Drill



**SA61076 3/8"**  
**SA61077 1/2"**  
Air Drill



**SA61078 3/8"**  
**SA61079 1/2"**  
Air Drill



**SA6122MC**  
MT2 Air Reversible Drill  
w/ Outside trigger  
w/ Morse Taper Chuck



**SA6123MC**  
MT2 Air Reversible Drill  
w/ Inside trigger  
w/ Morse Taper Chuck



**SA6169MC**  
MT2 Air Reversible Drill  
w/ Morse Taper Chuck



Model No.	Chuck Size		Free Speed	Net Weight		Overall Length		Air Cons		Air Inlet	Hose Size	
	夾頭尺寸		無負載轉速	重量		長度		耗氣量		進氣口	氣管	
	Inch	mm	R.P.M	lb	kg	Inch	mm	CFM	l/min	NPT/PT	Inch	mm
SA61026	5/16	8	2800	2.4	1.1	7.2	182	19.4	549.3	1/4"	3/8	10
SA61027	1/4	6	4300	2.4	1.1	6.9	176	19.4	549.3	1/4"	3/8	10
SA61084	1/4	6	2800	1.8	0.8	5.7	146	6.0	170	1/4"	3/8	10
SA61074/SA61075	3/8,1/2	10/13	1200	2.2	1.0	5.5	140	0.8	22.7	1/4"	8x12	
SA61076/SA61077	3/8,1/2	10/13	1900	2.2	1.0	5.5	140	0.8	22.7	1/4"	8x12	
SA61078/SA61079	3/8,1/2	10/13	2100	2.2	1.0	5.5	140	0.8	22.7	1/4"	8x12	
SA6122MC	MT2		1000	13.5	6.1	17.5	445	15	424	3/8"	3/8	10
SA6123MC	MT2		1000	13.5	6.1	17.5	445	15	424	3/8"	3/8	10
SA6169MC	MT2		1100	12.3	5.6	13.0	330	16	452	3/8"	3/8	10



# Air Drill

## 氣鑽

**SA61086**  
Morse Taper1 Air Drill w/ Comfort Grip

- Sug.Air Comp: 3HP



**SA61029KL**  
3/8" High Speed Drill



**SA61085** ★★ ★  
Heavy Duty Rotary Air Impact Drill  
(2100-3800RPM) Hammer Type



**SA61080** ★★ ★  
1/4"Angle Steel Air Drill



**SA61081** ★★ ★  
1/4"Angle Steel  
5" Extended Air Drill



**SA61082** ★★ ★  
1/4"Angle Steel 8" Extended Air Drill



Model No.	Chuck Size		Horse Power		Free Speed	Net Weight		Overall Length		Air Cons		Air Inlet	Hose Size	
	夾頭尺寸		馬力		無負載轉速	重量		長度		耗氣量		進氣口	氣管	
	Inch	mm	hp	kw	R.P.M	lb	kg	Inch	mm	CFM	l/min	NPT/PT	Inch	mm
SA61086	M.T.1		0.8	0.6	800	3.67	1.67	9.59	243	10	283	1/4"	3/8	10
SA61029KL	3/8	10	0.5	0.375	21000	1.87	0.85	8.89	226	4	113.2	1/4"	3/8	10
SA61085	1/2	13	-	-	2100-3800	13.2	6.0	14.9	380	28.3	801.2	3/8"	3/8	10
SA61080	1/4	6.35	0.5	0.375	12000	4.4	2.0	10.37	263.5	5	141.6	1/4"	3/8	10
SA61081	1/4	6.35	0.5	0.375	11000	4.2	1.9	14.23	361.5	3.5	99.1	1/4"	3/8	10
SA61802	1/4	6.35	0.5	0.375	11000	4.6	2.1	19.23	488.5	3.5	99.1	1/4"	3/8	10



# Industrial Air Drill

## 工業級氣鑽



### Industrial Keyed Chuck

- Spindle with special heat treatment
- Planet industrial strength gear train provide durability for heavy duty drilling
- Needle bearing
- Special steel cylinder

### Improved Muffler Design

Reversible bar on both sides  
one-hand operation

All drill offer ergonomic to provide  
max comfort during operation

Comfort grip handle



Model No.	Chuck Size	Chuck Run-Out	Free Speed	Spindle	Air Cons	Air Exhaust	Weight	Length	Motor	
	夾頭尺寸	同心度	無負載轉速	主軸	耗氣量	排氣	重量	長度	馬力	
	inch	mm	RPM	-	CFM	-	kg	mm	HP	
SA61060	3/8	0.07	2100	3/8"-24	4	Handle	1.04	215	0.6	Reversible
SA61061	1/2		350	1/2"-20			1.4	252		
SA61114	1/4		6000	3/8"-24			0.95	200		
SA61115	3/8		6000	3/8"-24			0.95	215		
SA61116	1/4	0.07	4000	3/8"-24	4	Handle	1	185	0.6	Non-Reversible
SA61117	3/8		4000	3/8"-24			1	200		
SA61065	1/2		500	1/2"-20			1.4	240		
SA61062	3/8		2800	3/8"-24			1	200		
SA61118	1/4		6000	3/8"-24			0.95	185		
SA61119	3/8		6000	3/8"-24			0.95	200		
SA61120	1/2		700	1/2"-20			1.4	240		
SA61063	3/8		2000	3/8"-24			1.1	234		
SA61121	3/8	0.07	3000	3/8"-24	4	Handle	1.1	234	1	Reversible
SA61064	1/2		1000	1/2"-20			1.6	272		
SA61122	1/2		300	1/2"-20			1.5	272		
SA61123	3/8	0.07	3800	3/8"-24	4	Handle	1.1	218	1	Non-Reversible
SA61124	1/4		4000	3/8"-24			1.05	204		
SA61125	3/8		2600	3/8"-24			1.1	218		
SA61126	1/2		1000	1/2"-20			1.5	258		
SA61127	3/8		21000	3/8"-24			1.04	225		
SA61128	1/2		3300	1/2"-20			1.1	232		
SA61129	1/2		2600	1/2"-20			1.1	232		

### SA8734

#### Portable Air Drilling Machine (Include Vacuum Suction Fixing Base)

- The novel vacuum suction fixing base can apply to coarse surfaces such as cement wall, lumber plywood, stone back, etc.
- The vacuum suction firms the machine onto the surface of the wall firmly and directly free of extra fixing devices.( It is necessary to confirm that the vacuum suction works indeed onto the surface prior to releasing the machine. )
- The air source shared by the vacuum suction and the machine demands one vent pipe only. Don't need two air sources.
- The water yield is valve-controllable and the water comes from either the drill chuck or the bores.
- The machine has stepless speed regulation and the max. free speed is 1,500 rpm.
- The ON/OFF switch controls over rapid and slow feed / escape.
- Drilling Machine can work with the small 4hp air compressor without the additional vacuum pump (vacuum generator)

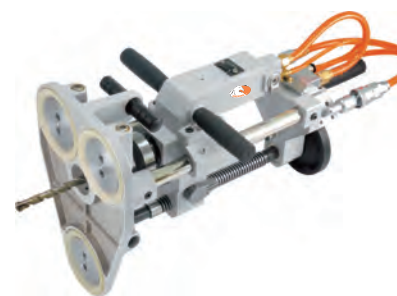

Model No.	Drill Chuck Size	Max. Drilling Capacity		Free Speed	Suction Cup Size	Drilling Bore Size	Air Cons		Air Pressure		Weight	Sound Pressure
	氣鑽夾頭尺寸	最大鑽孔直徑		無負載轉速	吸盤尺寸	鑽孔缸徑	耗氣量		工作壓力		重量	噪音值
	Inch	Iron	Stone	R.P.M	-	mm	m <sup>3</sup> /min	SCFM	psi	bar	kgs	dBA
SA8734	1/2	1/2"	40mm	1500	86mm x 3pcs	43	0.56	20	90	6.3	9.53	92



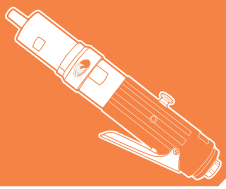

# Air Tapping Tool

## 氣動攻牙工具

### EA-0001S(E)(N)(U)

**Extension Arm w/ Tool Set**      Extended Span Length: 200-980mm

Contents	
1PC	Extension Arm:Holding Max.44mm Tapping Capacity Tool
1PC	SA8214P Air Tapping Tool w/o Chuck
1PC	1/4" Fr.L Combination Unit Manual Drain
1PC	#1 Small Quick Change Taper For B12 Spindle Tapper
1PC	Hose 6x4x110cm
1PC	Hose Adapter
1PC	1/4" Male Brass Plug

- Tapping Chuck Optional, Capacity: M3-M12
- Universal Joint Optional Model No.EA-0001S-1UJ



☆☆☆

### EA-0002S(E)(N)(U)

**Extension Arm w/ Tool Set**      Extended Span Length: 200-1050mm

Contents	
1PC	Extension Arm:Holding Max.57mm Tapping Capacity Tool
1PC	SA8232 Air Tapping Tool w/o Chuck
1PC	1/4" Fr.L Combination Unit Manual Drain
1PC	#1 Small Quick Change Tapper For B16 Spindle Tapper
1PC	Hose 6x4x130cm
1PC	Hose Adapter
1PC	1/4" Male Brass Plug

- Tapping Chuck Optional, Capacity: M6-M24
- Universal Joint Optional Model No.EA-0002S-1UJ



☆☆☆

### EA-0001

☆☆☆☆

**Extension Arm**

- For Holding Max: M3-M12 Tapping Capacity Tool
- Extended Span Length: 200-980



### EA-0002

☆☆☆☆

**Extension Arm**

- For Holding Max: M6-M24 Tapping Capacity Tool
- Extended Span Length: 200-1050



### SA8256

☆☆☆☆

**Air Tapper Tool w/ B12 Spindle w/ o Collet**

- Chuck Size: JT1 3/8"



### SA8214PA

☆☆

**Air Tapping Tool w/ o Tapping Accessories**

- Full Cage Gear System
- Capacity: M3-M12
- Air Cons: 3.22CFM



### SA8246PA

☆☆

**Air Tapping Tool w/ o Tapping Accessories**

- Full Cage Gear System
- Capacity: M3-M12
- Air Cons: 3.22CFM



Model No.	Free Speed	Spindle Type	Air Inlet	Air Pressure		Hose Size	Overall Length		Net Weight	
	無負載轉速	轉軸	進氣口	空氣壓力		氣管	長度		重量	
	R.P.M	-	NPT(PT)	psi	bar	ID	Inch	mm	lb	kg
SA8256	1400	B12	1/4"	90	6.2	3/8"	8.4	213	3.3	1.5
SA8214PA	400	B12	1/4"	90	6.2	3/8"	10.2	260	2.7	1.2
SA8246PA	400	B16	1/4"	90	6.2	3/8"	10.2	260	2.7	1.2



# Torque Control Air Screwdriver

## Full-Auto/Semi-Auto Shut Off (全自動/半自動停止) 扭力控制螺絲起子

**SA6342A 5mm Hex**  
**SA6342B 1/4"**  
**Full-Auto Shut Off**  
**Torque Control Screwdriver**



A 5mm Hex  
 B 1/4" (6.35mm)

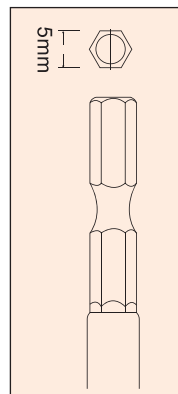

**SA6277(AL)**

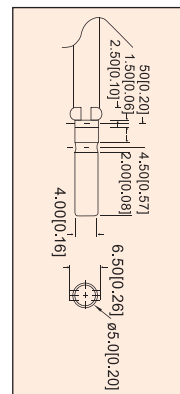

**SA6277**  
**1/4" Semi-Auto Shut Off**  
**Torque Control Screwdriver**



**SA6277AL**  
**1/4" Semi-Auto Shut Off**  
**Torque Control Angle Screwdriver**



**SA6409A 5mm Hex**  
**SA6409B 1/4"**  
**1/4" Semi-Auto Shut Off**  
**Torque Control Screwdriver**



**SA6409AL**  
**1/4" Semi-Auto Shut Off**  
**Torque Control Angle Screwdriver**



Model No.	Chuck Size	Bolt Capacity	Max Torque			Free Speed	Net Weight		Overall Length		Air Cons		Air Inlet	Hose Size
	夾頭尺寸	螺栓能力	最大扭矩			無負載轉速	重量		長度		耗氣量		進氣口	氣管
	Inch(Hex)	mm	ft-lb	N-m	kg/cm	R.P.M	lb	kg	Inch	mm	CFM	l/min	NPT(PT)	Inch
SA6342A	5mm	2.5 - 4	0.3 - 1.3	0.4 - 1.8	4 - 18	1000	1.4	0.62	9.1	230	7.1	201	1/4"	1/4
SA6342B	1/4	2 - 3.5	0.3 - 1.3	0.4 - 1.8	4 - 18	1000	1.4	0.62	9.1	230	7.1	201	1/4"	1/4
SA6409A	5mm	2 - 3.5	0.3 - 1.5	0.4 - 2.0	4 - 20	1000	1.4	0.62	9.3	235	7.1	201	1/4"	1/4
SA6409B	1/4	2 - 3.5	0.3 - 1.5	0.4 - 2.0	4 - 20	1000	1.4	0.62	9.3	235	7.1	201	1/4"	1/4
SA6409AL	1/4	2 - 3.5	0.6 - 1.9	0.8 - 2.6	8 - 27	1000	1.8	0.82	11.2	285	7.1	201	1/4"	1/4
SA6277	1/4	2 - 3.5	0.1 - 1.1	0.2 - 1.5	2 - 15	1000	1.2	0.56	8.7	220	7.1	201	1/4"	1/4
SA6277AL	1/4	2 - 3.5	0.1 - 1.1	0.2 - 1.5	2 - 15	1000	1.6	0.72	10.4	265	7.1	201	1/4"	1/4



# Air (Impact) Screwdriver

## 1/4" 氣動(衝擊型)螺絲起子

www.airprotool.com

**SA6296**  
1/4" Air Impact Screwdriver

- Two Hammer Mechanism
- Sug Air Comp.: 3HP



**SA6297**  
1/4" Air Impact Screwdriver

- Two Hammer Mechanism
- Sug Air Comp.: 3HP



**SA6298**  
1/4" Air Impact Screwdriver

- Two Hammer Mechanism
- Sug Air Comp.: 3HP



**SA6374**  
1/4" Composite Adjustable Clutch Air Screwdriver



**SA6375**  
1/4" Composite Adjustable Clutch Air Screwdriver



**SA6377**  
1/4" Air Screwdriver



- Dia: 6.35mm



**SA6397**  
1/4" Composite Adjustable Clutch Air Screwdriver

- Handle exhaust



**SA6398**  
1/4" Direct Driver Type Composite Air Screwdriver

- For Woodworking Screws



**SA6399**  
1/4" Direct Driver Type Composite Air Screwdriver

- For Woodworking Screws



Model No.	Chuck Size	Max Torque		Free Speed	Bolt Capacity		Net Weight		Overall Length		Air Cons		Air Inlet		Hose Size	
	夾頭尺寸	最大扭矩		無負載轉速	螺栓能力		重量		長度		耗氣量		進氣口		氣管	
	Inch(Hex)	ft-lb	N-m	R.P.M	Inch	mm	lb	kg	Inch	mm	CFM	l/min	PT/NPT	Inch	mm	
SA6296	1/4	115	156	9000	1/4	6	2.6	1.2	6.1	155	12	339.7	1/4"	1/4	6.35	
SA6297	1/4	145	197	9000	5/16	8	2.6	1.2	6.1	155	12	339.7	1/4"	1/4	6.35	
SA6298	1/4	175	237	8500	3/8	10	2.6	1.2	6.1	155	12	339.7	1/4"	1/4	6.35	
SA6377	1/4	-	-	8500	6-8mm		2.0	0.9	5.5	140	18.7	529.4	1/4"	3/8	10	
SA6374	1/4	11.7	15.8	1800	1/4	6	2.9	1.3	7.6	195	4	113.2	1/4"	3/8	10	
SA6375	1/4	14.6	19.8	800	1/4	6	3.5	1.6	8.2	210	4	113.2	1/4"	3/8	10	
SA6397	1/4	12.5	17	2500	1/4	6	2.4	1.1	8.3	212	10	283	1/4"	3/8	10	
SA6398	1/4	-	-	2500	5/32	4	2.0	0.9	6.1	155	10	283	1/4"	3/8	10	
SA6399	1/4	-	-	1000	3/16	5	2.3	1.0	6.8	172	10	283	1/4"	3/8	10	





# Air (Impact) Screwdriver & Torque Tester

## 1/4" 氣動(衝擊型)螺絲起子 & 扭力測試機

### SA6390 1/4" Air Impact Screwdriver

- Two Hammer Mechanism
- Sug Air Comp.: 2HP



### SA6391 1/4" Air Impact Screwdriver

- Two Hammer Mechanism
- Sug Air Comp.: 2HP



### SA6392 1/4" Air Impact Screwdriver

- Two Hammer Mechanism
- Sug Air Comp.: 2HP



### SA6388 1/4" Air Impact Screwdriver

- Two Hammer Mechanism
- Sug Air Comp.: 2HP



### SA6389 1/4" Air Impact Screwdriver

- Two Hammer Mechanism
- Sug Air Comp.: 2HP



### SA6420 1/4" Air Screwdriver



Model No.	Chuck Size	Max Torque		Free Speed	Bolt Capacity		Net Weight		Overall Length		Air Cons		Air Inlet	Hose Size	
	夾頭尺寸	最大扭矩		無負載轉速	螺栓能力		重量		長度		耗氣量		進氣口	氣管	
	Inch (Hex)	ft-lb	N-m	R.P.M	Inch	mm	lb	kg	Inch	mm	CFM	l/min	PT/NPT	Inch	mm
SA6390	1/4	100	136	8000	1/4	6	2.29	1.04	7.83	199	7	198.1	1/4"	1/4	6.35
SA6391	1/4	125	170	8000	5/16	8	2.29	1.04	7.87	200	7	198.1	1/4"	1/4	6.35
SA6392	1/4	155	210	7500	3/8	10	2.36	1.07	8.07	205	6	169.8	1/4"	1/4	6.35
SA6388	1/4	100	136	8500	1/4	6	2.62	1.19	9.06	230	7	198.1	1/4"	3/8	10
SA6389	1/4	125	170	8500	5/16	8	2.67	1.21	9.06	230	7	198.1	1/4"	3/8	10
SA6420	1/4	5sec 34±10% N.M		8000	M6-M8		2.14	0.97	7.87	200	10.6	300.1	1/4"	-	

### TWTB Series Multi-Function Torque Tester For Air , Electric Screwdriver



#### Display:

- Same time display of torque value & B.P.M., also available to set High, Low Pass torque value .
- Applicable to test forward, reverse torque value, optional to auto reset to zero & time to reset zero.
- Torque value unit: Nm, lbf.ft, lbf.in, kgf.m, kgf.cm
- The strength of filter wave is adjustable anytime, to reach its optimum state.

#### Transducer:

- Torque Range: 0.5~500 Nm.
- Accuracy: better than ±3%.
- With standard RS232 interface, connect to computer or printer with specific software.
- Voltage: AC100V~240V auto shift.



Model No.	Measurement Range	Application			
		Impact Type	Oil Pulse Type	Cushion Type	Manual Type
		■ (in)	■ (in)	■ (in)	■ (in)
TWTB-0.5	0.025 - 0.5			1/4	1/4
TWTB-1	0.05 - 1		1/4	1/4	1/4
TWTB-2	0.1 - 2		1/4	1/4	1/4
TWTB-3	0.15 - 3		1/4		1/4
TWTB-4	0.2 - 4		1/4		1/4
TWTB-5	0.25 - 5		1/4	1/4	1/4
TWTB-10	0.5 - 10		1/4	1/4	1/4
TWTB-20	1 - 20		1/4	1/4	1/4
TWTB-25	1.25 - 25	1/4			1/4
TWTB-30	1.5 - 30		3/8 1/4		3/8 1/4
TWTB-40	2 - 40		3/8 1/4		3/8 1/4
TWTB-50	2.5 - 50	1/4 3/8			1/4 3/8
TWTB-100	5 - 100	1/4 3/8 1/2			1/4 3/8 1/2
TWTB-250	12.5 - 250	3/8 1/2			3/8 1/2
TWTB-500	25 - 500	3/8 1/2			3/8 1/2



**SA8264**  
**SA8264H W/Hose**  
**Vibration Reduced**  
**Air Body Saw**



**SA8259**  
**Vibration Reduced Compact**  
**Mini Air Body Saw**

- Metal Housing



**SA8259K**  
**Mini Air Body Saw Kit**

Contents

- 1PC 3mm Hex Wrench
- 5PCS 18T Metal Saw Blade
- 5PCS 24T Metal Saw Blade
- 5PCS 36T Metal Saw Blade



**SA8257**  
**Low Vibration Air Body Saw**

- Cutting Capacity(Alu.):3.2mm



**SA8260**  
**Reciprocating Air Roofing Cutter**

- Metal Housing



**SA8260K**  
**Reciprocating Air Roofing Cutter Kit**

Contents

- 1PC 3mm Hex Wrench
- 5PCS 3.5" Hook Roofing Cutter Blades
- 15PCS Each 18T,24T,36T Bi-Metal Saw Blade x 5pcs
- 1PC Universal Swivel Air Inlet Joint



**SA8263**  
**Super Duty Vibration-Damped**  
**Air Body Saw**



**SA8261**  
**Reciprocating Air Roofing Cutter**

- Composite Housing



**SA8261K**  
**Reciprocating Air Roofing Cutter Kit**

Contents

- 1PC 3mm Hex Wrench
- 5PCS 3.5" Hook Roofing Cutter Blades
- 15PCS Each 18T,24T,36T Bi-Metal Saw Blade x 5pcs
- 1PC Universal Swivel Air Inlet Joint



Model No.	Stroke Length	Free Speed	Air Inlet	Net Weight		Overall Length		Air Pressure		Air Cons		Noise Level
	行程	無負載轉速	進氣口	重量		長度		空氣壓力		耗氣量		噪音值
	mm	B.P.M	NPT(PT)	lb	kg	Inch	mm	psi	bar	CFM	l/min	dB(A)
SA8264(H)	10	10000	1/4"	1.9	0.9	10.2	260	90	6.3	3	84.9	85 / 80
SA8257	10	10000	1/4"	1.2	0.6	16.73	425	90	6.3	2	56.6	79
SA8263	14	10000	1/4"	1.37	0.62	8.9	227	90	6.3	2.3	65	-
SA8259	10	10000	1/4"	1.1	0.5	8.9	225	90	6.3	7.6	215	80.4
SA8260	10	9500	1/4"	1.5	0.7	9.4	238	90	6.3	3.5	100	85
SA8261	10	9500	1/4"	1.1	0.5	10.6	270	90	6.3	3.5	100	85



# Special Air Tool 特殊氣動工具

**SA8535A 3"**  
**SA8568A 4"**  
**Cut-Off Tool w/ Lock Pin**  
**w/ o Cutting Wheel**  
**w/ 360° Rotatable Wheel Guard.**

- SA8535A: Motor 0.5 Hp
- SA8568A: Motor 0.7 Hp



**SA8572**  
**4" Air Cutter w/ Rotatable**  
**Wheel Guard**  
**w/Spindle Lock System**

- Motor 1 Hp



**SA5218K 1/4"**  
**SA5218KM 6MM**  
**90° Low Noise Air Angle**  
**Die Grinder**  
**w/ Carbide Cutter Kit**

- Motor 0.5 Hp
- Cutting Wheel 25x4 Dia



**SA210144**  
**(Shaft for 6mm collet)**  
**SA210144.1**  
**(Shaft for 1/4" collet)**  
Shaft for Cutting Depth  
0.8mm for 25mm Cutting  
Wheel



**SA210144.2**  
**(Shaft for 6mm collet)**  
**SA210144.3**  
**(Shaft for 1/4" collet)**  
Shaft for Cutting Depth  
1.0mm for 25mm Cutting  
Wheel

**SA8990** ★★ ★  
**Pistol Rivet Shavers Cutter**

- Motor: 0.9HP
- Cutting Diameter: 1/2"



**SA8735**  
**Spot Welding Tip Sharpener**



**SA8601K2**  
**Air Knife Kit w/ Rubber**  
**Hand Grip**  
**w/ Silence Hose**



Stroke Arc: 1~3 Degree

### Contents

- 1PC SA8601 Air Knife
- 3PCS Standard Knives
- 1PC Pin Spanner
- 1PC Open Wrench
- 4PCS Special Cutting Blades
- 1PC Sanding Pad (40 grit) w/Sanding Paper

**SA88100**  
**Hand Chamfering**  
**Tools w/ Blade**

- Rear Exhaust



**SA8573**  
**Air Angle Eraser w/ Eraser**

- Motor: 0.5HP
- Spindle: 5/16"-24



**SA8574**  
**Air Angle Eraser w/ Eraser**

- Motor: 1.0HP
- Spindle: 5/16"-24



**PAD-29756-1**  
Eraser Wheel Hub

**PAD-29756**  
Eraser Wheel  
4.1"(104mm)

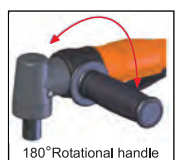

Model No.	Free Speed	Air Cons		Air Inlet	Air Pressure		Overall Length		Net Weight		Noise Level
	無負載轉速	耗氣量		進氣口	空氣壓力		長度		重量		噪音值
	R.P.M	CFM	L/min	PT/NPT	psi	bar	Inch	mm	lb	kg	dBA
SA8535A	18000	4	113	1/4"	90	6.3	8.8	225	1.8	0.83	85
SA8568A	13000	4.5	127	1/4"	90	6.3	240x105x125mm		2.04	0.93	85
SA8572	17900	4.1	116	1/4"	90	6.3	8.7	220	2.2	1.0	85
SA5218K(KM)	11000	3.5	99.1	1/4"	90	6.3	7.0	180	1.5	0.7	-
SA8990	21000	4.0	113.2	1/4"	90	6.3	10.2	260	2.65	1.2	85
SA88100	28000	2.0	56.6	1/4"	90	6.3	5.3	135	1.1	0.5	85
SA8601	20000	12.4	350	1/4"	90	6.3	7	180	2.2	1.0	-
SA8573	2500	3.5	99.1	1/4"	90	6.3	8.6	220	2.2	1.0	-
SA8574	2500	4.1	116	1/4"	90	6.3	8.8	225	3.1	1.4	-

Model No.	Spindle Size	Free Speed	Air Cons		Air Inlet	Air Pressure		Net Weight		Exhaust System
	主軸尺寸	無負載轉速	耗氣量		進氣口	空氣壓力		重量		排氣方式
	-	R.P.M	CFM	L/min	NPT	psi	bar	lb	kg	-
SA8735	3/8-24T	1900	9.9	280	1/4"	90	6.3	2	0.9	Rear





# Air Hydraulic Riveter

## 氣動油壓拉釘槍

www.airprotool.com

### SA8890V

**5/32" Air Hydraulic Riveter  
w/ Vacuum Mandrel Collection System**

- Rivet Capacity:  
1/8"(3.2mm), 5/32"(4.0mm)



### SA8891V

**5/32" Air Hydraulic Riveter  
w/ Vacuum Mandrel Collection System**

- Rivet Capacity: 3/32"(2.4mm),  
1/8"(3.2mm), 5/32"(4.0mm)



### SA8894

**3/16" Air Hydraulic Riveter**

- Nosepieces: 1/8"(3.2mm),  
5/32"(4.0mm), 3/16"(4.8mm)  
- Air Cons: 4CFM(113.2 l/min)



### SA8895

**3/16" Air Hydraulic Riveter**

- Nosepieces: 3/32"(2.4mm), 1/8"(3.2mm),  
5/32"(4.0mm), 3/16"(4.8mm)  
- Air Cons: 4CFM(113.2 l/min)



### SA8886V

**3/16" Air Hydraulic Riveter  
w/ Vacuum Mandrel Collection System**



- Rivet Capacity: 1/4"(6.4mm),  
7/32"(5.6mm), 3/16"(4.8mm)  
- Air Cons: 4CFM(113.2 l/min)



### SA8993V

**3/16" Air Hydraulic Riveter  
w/ Vacuum Mandrel Collection System**

- Rivet Capacity: 3/32"(2.4mm), 1/8"(3.2mm),  
5/32"(4.0mm), 3/16"(4.8mm)



Model No.	Traction Power		Rivet Capacity		Stroke Length		Net Weight		Length		Air Pressure	
	拉力		拉釘規格		行程		重量		長度		空氣壓力	
	lb.f	kg.f	Inch	mm	Inch	mm	lb	kg	Inch	mm	psi	bar
SA8890V	1300	600	5/32	4	0.63	16	3	1.4	9.5	242	85-110	5.9-7.6
SA8891V	1300	600	5/32	4	0.63	16	3.3	1.5	10.0	250	85-110	5.9-7.6
SA8894	1983	899	3/16	4.8	0.63	16	3.3	1.5	11.7	298	85-100	5.9-6.9
SA8895	1940	880	3/16	4.8	0.55	14	3.3	1.5	10.7	273	85-100	5.9-6.9
SA8886V	4000	1816	3/16	4.8	1.02	26	4.2	1.9	13.0	325	70-95	4.9-6.7
SA8993V	2090	950	3/16	4.8	0.75	19	2.2	1.0	11.2	284	71-85	4.9-5.9



# Air Hydraulic Riveter, Nut Riveter & Lockbolt

## 氣動油壓拉釘槍, 拉帽槍 & 哈克槍

**SA8887V**  
**3/16" Air Hydraulic Riveter**  
**w/ Vacuum Mandrel Collection System**

- Rivet Capacity: 1/8"(3.2mm),  
 5/32"(4.0mm),3/16"(4.8mm)



**SA8888V**  
**1/4" Air Hydraulic Riveter**  
**w/ Vacuum Mandrel Collection System**

- Rivet Capacity: 1/8"(3.2mm),5/32"(4.0mm),  
 3/16"(4.8mm),1/4"(6.3mm)



**SA8889V**  
**3/16" Air Hydraulic Riveter**  
**w/ Vacuum Mandrel Collection System**

- Rivet Capacity: 1/8"(3.2mm),  
 5/32"(4.0mm),3/16"(4.8mm)



**SA8952** ★★★★★  
**Air Hydraulic Riveter Nut Tool**

- Rivet Nut Setting Capacity: M3 (#6-32),  
 M4 (#8-32), M5 (#10-24 or #10-32 ),  
 M6 (1/4"-20), M8 (5/16"-18)  
 - Air Cons: 2.1liter



**SA8944** ★★★★★  
**Air Hydraulic Composite Lockbolt Tool**

- Capacity Huckbolt/Avdel: 3/16"(4.8mm),  
 1/4"(6.4mm)  
 - Air Cons: 0.2m³(0.01stroke)  
 - Using for HUCK C6L Fasteners &  
 AVDEL Avdelok.  
 - Option application for HUCK  
 Magna-Grip & AVDEL Maxlok.  
 - Cylinder Dia: 4"(100mm)



**SA8992** ★★★★★  
**3/8" Air Hydraulic Lock Bolt**  
**Installation Tool**  
**SA8992D**  
**3/8" Air Hydraulic Lock Bolt**  
**Installation Tool w/Digital Module**

- Capacity: 3/8" Alum. Multi Grip Lock Bolt



Model No.	Traction Power		Rivet Capacity		Stroke Length		Net Weight		Length		Air Pressure	
	拉力		拉釘規格		行程		重量		長度		空氣壓力	
	lb.f	kg.f	Inch	mm	Inch	mm	lb	kg	Inch	mm	psi	bar
SA8952	3200	1452	M3-M8		0.27	7	4.6	2.1	12.0	305	85-95	5.9-6.5
SA8887V	2100	950	3/16	4.8	0.71	18	3.4	1.54	10.2	260	90	6.3
SA8888V	3500	1600	1/4	6.3	0.75	19	3.6	1.65	12.0	305	90	6.3
SA8889V	2750	1250	3/16	4.8	0.98	25	4.6	2.1	12.2	310	90	6.3
SA8944	5060	2300	1/4	6.4	0.75	19	5	2.3	13.2	336	90-110	6.3-7.6
SA8992(D)	7050	3200	3/8	10.0	0.51	13	6.4	2.9	13.8	350	90	6.3



# Air Nut Riveter

## 氣動拉帽槍

www.airprotool.com

**SA8950**  
**SA8950Q**



**Air Riveter Nut Tool**  
**w/Two Size Riveting Head**

- Rivet Nut Setting Capacity: M3,M4,M5
- SA8950Q: Quick Change Nose Head

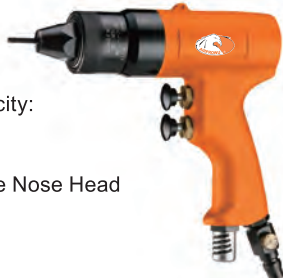

**SA8957**  
**SA8957Q**



**Air Riveter Nut Tool**  
**w/Two Size Riveting Head**

- Rivet Nut Setting Capacity: M6,M8
- SA8957Q: Quick Change Nose Head



**SA8958 M10,M12**  
**SA8958Q M8,M10**



**Air Riveter Nut Tool**  
**w/Two Size Riveting Head**

- SA8958Q: Quick Change Nose Head



**SA8961(S) M3(1/8")**  
**SA8962(S) M4(5/32")**  
**Air Nut Riveter Tool**

- Sug. Air Comp.: 3HP"



**SA8963(S) M5(3/16")**  
**SA8964(S) M6(1/4")**  
**Air Nut Riveter Tool**

- Sug. Air Comp.: 3HP



**SA8965(S)**  
**M8(5/16") Air Nut Riveter Tool**

- Sug. Air Comp.: 3HP



**SA8980 1500RPM**  
**SA8981 600RPM**  
**SA8982 400RPM**  
**Air Nut Riveter**  
**w/Two Size Riveting Head**

- SA8980: M5,M6
- SA8981: M6,M8
- SA8982: M8,M10



**SA8984**  
**Air Nut Riveter**  
**w/Two Size Riveting Head**

- SA8984: M5,M6



**SA8988**  
**90° Angle Air Nut Riveter**  
**w/Two Size Riveting Head**

- SA8988: M5x2 or M5,M6



Model No.	Capacity	Free Speed	Net Weight		Length		Air Pressure		Air Cons		Air Inlet	
	拉帽能力	無負載轉速	重量		長度		空氣壓力		耗氣量		進氣口	
	-	R.P.M	lb	kg	Inch	mm	psi	bar	CFM	l/min	Inch	mm
SA8950(Q)	M3-M5	1200	2.49	1.13	4.09	104	90	6.3	5.7	160	1/4	6.35
SA8957(Q)	M6-M8	600	2.8	1.27	8.0	203	90	6.3	5.7	160	1/4	6.35
SA8958(Q)	M8-M12	400	2.84	1.29	8.19	208	90	6.3	5.7	160	1/4	6.35
SA8961(S)	M3,1/8"	2100	2.8	1.27	7.95	202	90	6.3	10	285	1/4	6.35
SA8962(S)	M4,5/32"	2100	2.8	1.27	7.95	202	90	6.3	10	285	1/4	6.35
SA8963(S)	M5,3/16"	800	3.5	1.56	8.74	222	90	6.3	10	285	1/4	6.35
SA8964(S)	M6,1/4"	800	3.5	1.56	8.74	222	90	6.3	10	285	1/4	6.35
SA8965(S)	M8,5/16"	500	3.5	1.56	9.17	233	90	6.3	10	285	1/4	6.35
SA8980	M5-M6	1500	3.3	1.5	7.48	190	100	6.9	4.9	139	3/8	10
SA8981	M6-M8	600	3.3	1.5	8.46	215	100	6.9	4.9	139	3/8	10
SA8982	M8-M10	400	3.3	1.5	8.46	215	100	6.9	4.9	139	3/8	10
SA8984	M5-M6	1500	2.4	1.1	8.66	220	100	6.9	4.9	139	3/8	10
SA8988	M5-M6	1100	2.4	1.1	220x100		100	6.9	4.9	139	3/8	10





# Hand Riveter & Hand Nut Riveter

## 手動拉釘槍 & 手動拉帽槍

### HN-009K Aluminum Nut Riveter Kit

- Contents:  
#6-32,#8-32,  
#10-24,#1/4-20



### HN-008K Iron Nut Riveter Kit

- Contents:  
M3,M4,M5,M6



### SERG-H64D / SERG-H64DN 1/4" Aluminum Rivet-I-Head



### HR-806 3/16" Heavy Duty 11" Hand Riveter

- Max working  
stroke: 9mm
- Max multiple of arm force: 25
- Weight: 600g, Length: 280mm
- Applicable to Steel, Stainless Steel,  
Aluminum Rivets



### HR-958 8" Length Mirco Hand Riveter

- Max working stroke: 7mm
- Max multiple of arm force: 27
- Weight: 500g, Length: 200mm
- Applicable to Steel, Stainless Steel,  
Aluminum Rivets



### HR-009 Manual Hand Riveter



### HR-001K Hand Plastic Riveter Kit w/40PCS Rivets

- Contents  
10pcs 6.3x25.2mm  
10pcs 6.6x17.2mm  
10pcs 5.0x15.8mm  
10pcs 5.0x17.2mm



### HR-002K Hand Plastic Riveter Kit w/40PCS Rivet

- Contents  
10pcs 6.3x25.2mm  
10pcs 6.6x17.2mm  
10pcs 5.0x15.8mm  
10pcs 5.0x17.2mm



### HR-007 Hand Riveter Kit



### HR-008 Lazy Tong Hand Riveter



### HR-005K Ergonomic Riveter Kit

- Ergonomic Design  
Gives Large Riveting Force
- Contents: 100PCS Rivets



### HR-006K Riveter & Nut Riveter Mutli-Function Kit

- Contents: 100PCS Rivets,  
40PCS Rivet Nut



### HN-001K Ergonomic Nut Riveter

- Ergonomic Design  
Gives Large Riveting Force
- Contents: 40PCS Rivet Nut



### HN-605 13" Metric/SAE Hand Rivet Nut Kit w/Rivet Nut Assortment

- Contents:  
M3,M4,M5,M6,M8,M10
- Max working stroke: 9mm
- Max multiple of arm force: 30
- Weight: 1100g, Length: 330mm



Model No.	Rivet (Nut Rivet) Capacity
	拉釘(拉帽)能力
HR-001K	0.2"(5mm), 0.24"(6.3mm), 0.26"(6.6mm)
HR-002K	0.2"(5mm), 0.24"(6.3mm), 0.26"(6.6mm)
HR-007	3/32"(2.4mm), 1/8"(3.2mm), 5/32"(4.0mm), 1/8"(3.2mm) long size
HR-806	3/32"(2.4mm), 1/8"(3.2mm), 5/32"(4.0mm), only alum 3/16"(4.8mm)
HR-958	3/32"(2.4mm), 1/8"(3.2mm), 5/32"(4.0mm), only alum 3/16"(4.8mm)
HR-009	3/32"(2.4mm), 1/8"(3.2mm), 5/32"(4.0mm), 3/16"(4.8mm)
HR-008	2.4mm(3/32"), 3.2mm(1/8"), 4.0mm(5/32"), 4.8mm(3/16")
SERG-H64D(N)	3.2mm(1/8"), 4.0mm(5/32"), 4.8mm(3/16"), 6.4mm(1/4")
HN-009K	(#6-32),(#8-32), (#10-24), (1/4"-20)
HN-008K	M3, M4, M5, M6
HR-005K	3.2mm(1/8"), 4.0mm(5/32"), 4.8mm(3/16"), 6.4mm(1/4")
HR-006K	Rivet: 3.2mm(1/8"), 4.0mm(5/32"), 4.8mm(3/16"), 6.4mm(1/4") / Nut Rivet: M5, M6, M8, M10
HN-001K	M5, M6, M8, M10
HN-605	M3, M4, M5, M6, M8, M10



# Air Riveting Hammer

## 氣動鉚釘槍

www.airprotool.com

**SA7123** ★★★★★  
Air Riveting Hammer(100B Type)

-w/ Variable Speed Trigger



**SA7124** ★★★★★  
Air Riveting Hammer(2X Type)

- w/ Variable Speed Trigger



**SA7125** ★★★★★  
Air Riveting Hammer(4X Type)

- w/ Variable Speed Trigger



**SA7128** ★★★★★  
Air Riveting Hammer(5X Type)

-w/ Variable Speed Trigger



**SA7129** ★★★★★  
Air Riveting Hammer(7X Type)

- w/ Variable Speed Trigger



**SA7130** ★★★★★  
Air Riveting Hammer(9X Type)

- w/ Variable Speed Trigger



**RH-9502XK**  
**RH-9503XK**  
**RH-9504XK**  
Air Riveting Hammer Kit

Contents	
1PC	RH-9502X/RH-9503X/RH-9504X
2PCS	Retainer Spring
1PC	"T" Air Regulator
1PC	Oil Pot
1PC	Nipple
1PC	Thread Seal Type
5PCS	Hammer Chisel 3/16",5/32" 1/8",3/32",1"
1PC	Blow Molded Case



**RH-9505XK**  
**RH-9507XK**  
**RH-9509XK**  
Air Riveting Hammer Kit

Contents	
1PC	RH-9505X/RH-9507X/RH-9509X
2PCS	Retainer Spring
1PC	"T" Air Regulator
1PC	Oil Pot
1PC	Nipple
1PC	Thread Seal Type
5PCS	Hammer Chisel 3/16",5/32" 1/8",3/32",1-1/4"
1PC	Blow Molded Case



Model No.	Blows Per Minute	Riveting Capacity		Chisel Shank	Bore Diameter	Stroke Length	Air Cons	Air Inlet	Air Pressure		Hose Size	Net Weight	
	打擊次數	鉚合能力		柄徑孔	孔徑	行程	耗氣量	進氣口	空氣壓力		氣管	重量	
	B.P.M	Alum	Steel	Inch	mm	mm	CFM	NPT(PT)	psi	bar	ID	lb	kg
SA7123	2850	5/32"	1/8"	0.401	14.25	61	3.36	1/4"	90	6.2	3/8"	2.09	0.95
SA7124	2580	5/32"	3/32"	0.401	12.65	68	3.36	1/4"	90	6.2	3/8"	2.48	1.13
SA7125	1740	1/4"	3/16"	0.401	12.65	101	3.36	1/4"	90	6.2	3/8"	2.86	1.3
SA7128	1800	1/4"	3/16"	0.401	19	115	3.36	1/4"	90	6.2	3/8"	2.92	1.33
SA7129	1700	8mm	7mm	0.401	19	123	3.36	1/4"	90	6.2	3/8"	3.19	1.4
SA7130	1250	9.5mm	9mm	0.401	19	159	3.36	1/4"	90	6.2	3/8"	3.52	1.6



# Air Flux Chipper & Air Hammer

## 氣動除鏽鎚 & 氣動鎚

### SA7183 One Shot Hammer



- Power: 2.25Nm



### SA7187 One Shot Hammer



- Grip size: Ø 43mm  
- Blowing Power:  
(Approx.): 5.88Nm



### SA7184 Heavy Duty One Shot Hammer



- Grip size: Ø 43mm  
- Tank size: Ø 72mm  
- Blowing Power:  
(Approx.): 8.82Nm



### SA7435R Round Shank SA7435H Hex Shank Mini Two Bolt Chipping Hammer



- Chisel Shank:  
Round: 17.3 / Hex: 14.7mm



### SA7235 Flux Chipper

- Built-Power Regulator  
- w/quick change chuck w/1pc Nail  
Removal Chisel(8.5")



### SA7235K Flux Chipper Kit

Contents	
1PC	SA7235
1PC	Oil Pot
1PC	Nipple
3PCS	Chisel
1PC	Blow Molded Case



### SA8565 Pittsburgh Lock Seam Pistol Grip Hammer



### SA8555 Pittsburgh Lock Seam Pistol Grip Hammer



Low vibration metal loop valve(Optional accessories)

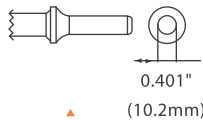

Chisel Shank 0.401"(10.2mm)Round

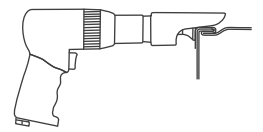
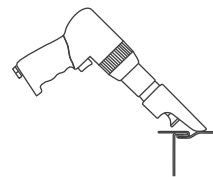
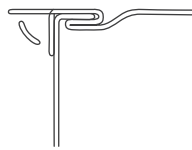

Model No.	Blows Per Minute	Avg. Air Cons	Air Inlet	Air Pressure		Hose Size		Net Weight		Overall Length		Piston Diameter		Piston Stroke(Length)	
	打擊次數	耗氣量	進氣口	空氣壓力		氣管		重量		長度		活塞直徑		活塞行程	
	B.P.M	CFM	NPT(PT)	psi	bar	ID	lb	kg	Inch	mm	Inch	mm	Inch	mm	
SA7183	-	220 cm³/stroke	1/4"	90	6.2	3/8"	1.98	0.9	8.4	213	-	-	-	-	
SA7184	-	1500 cm³/stroke	1/4"	72.6-101.6	5-7	3/8"	4.6	2.1	13.0	330	-	-	-	-	
SA7187	-	1200 cm³/stroke	1/4"	72.6-101.6	5-7	3/8"	3.5	1.6	12.9	328	-	-	-	-	
SA7235	4000	2.8	3/8"	90	6.2	3/8"	3.7	1.7	10.15	258	1.0	25.4	1.2	30	
SA8565	4200	6.2	1/4"	90	6.2	3/8"	4.9	2.2	10.2	260	0.8	19	2.0	50	
SA8555	3000	7.8	1/4"	90	6.2	3/8"	5.3	2.4	11.4	290	0.8	19	2.8	70	
SA7435R(H)	2940	17	3/8"	90	6.2	1/2"	9.7	4.4	15.4	390	1.1	27.9	1.8	46	





# Low Noise Air Tool

## 低噪音氣動工具

www.airprotool.com

**ST-252P 1/4"**  
**ST-252PM 6MM**  
**Reversible Low Noise**  
**Speed Air Die Grinder**



**SA61045**  
**3/8" Low Noise 90°**  
**Angle Air Reversible Drill**



**SALR-350**  
**Low Noise Air Nibbler**

- Power: 0.5HP  
 - Cutting Capacity:  
 (Steel ): 1.2mm /(Aluminum): 1.6mm



**ST-250RP**  
**3" Reversible Low Noise Air Cutter**



**SALR-255B 13000RPM**  
**SALR-256B 15000RPM**  
**4" Reversible Low Noise**  
**Air Axial Cutter**

- Spindle lock for disc replacement.



**SALR-254B**  
**4" Extended Reversible Low Noise**  
**Air Axial Cutter**

- Spindle lock for disc replacement.



**SALR-300**  
**Low Noise Air Metal Shear**  
**SALR-310**  
**Low Noise Air Scissors**

- Power: 0.5HP  
 - Cutting Capacity: (Steel )1.2mm  
 (Aluminum )1.6mm



SALR-310

**SAL-226-3 3"**  
**SAL-226-5 5"**  
**Low Noise Air**  
**Angle Sander / Polisher**

- Power: 0.5HP  
 - Spindle Thread: 5/16"-24



**SAL-227-3 3"**  
**SAL-227-5 5"**  
**Low Noise Air**  
**Angle Sander / Polisher**

- Power: 0.5HP  
 - Spindle Thread: 5/16"-24



Model No.	Wheel /Collet/PAD Size		Free Speed	Air Inlet	Net Weight		Overall Length		Air Hose		Air Cons	
	砂輪/夾頭/底盤尺寸				無負載轉速	進氣口	重量		長度		氣管	
	Inch	mm	RPM	NPT(PT)			lb	kg	Inch	mm	Inch	mm
ST-252P(M)	1/4	6	18000	1/4"	1.6	0.7	7.6	195	3/8	10	3.6	102
SA61045	3/8	10	1600	1/4"	2.4	1.1	8.2	210	3/8	10	3.6	102
ST-250RP	3	76	18000	1/4"	2	0.9	8	205	3/8	10	3.6	102
SALR-255B	4	101.6	13000	1/4"	2.4	1.1	9.4	240	3/8	10	3.6	102
SALR-256B	4	101.6	15000	1/4"	2.4	1.1	9.4	240	3/8	10	3.6	102
SALR-254B	4	101.6	15000	1/4"	2.4	1.1	14.5	370	3/8	10	3.6	102
SALR-350	-	-	2600	1/4"	2.2	1	7.8	200	3/8	10	3.1	87.8
SALR-300	-	-	2600	1/4"	2.2	1	10	255	3/8	10	3.1	87.8
SALR-310	-	-	2600	1/4"	2.2	1	11.4	290	3/8	10	3.1	87.8
SAL-226-3(5)	3(5)	76(125)	1800	1/4"	2.2	1	8	205	3/8	10	3.5	99.1
SAL-227-3(5)	3(5)	76(125)	4000	1/4"	2.2	1	7.8	200	3/8	10	3.1	87.8

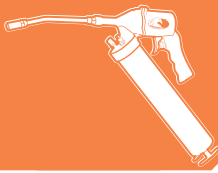

# Air Grease Gun, Air Caulking Gun & Sand Blaster Gun

## 氣動黃油槍, 填縫槍 & 噴砂槍

**CG282A 10.5oz**  
**CG282AXL 20oz**

### Pneumatic Dispensing Tool(Alum)

- Max.Thrust: 110kgs
- Air Supply: 8kg/cm<sup>2</sup>



**SBG129**

### Soda Blasting Gun

- Working Pressure: 90PSI(6.2Bar)
- Air Inlet: 1/4"
- Air Consumption: ca 150NL/Min
- Soda Consumption: ca 500g/min
- Extension Hose:  
2 M with 30cm Suction Tube
- Weight: 510g



**SA9030**

### Push Type Grease Gun

- Cap and Body with Black Oven Painted
- w/ Standard Needle Type Metallic Spout



**SA9007C**

### Grease Gun Injection Head w/4-Jaw Coupler

- Designed for quick grease jobs
- Squeeze tube(tube included) fit into zinc die cast body for easy dispensing.
- Lubrication Grease: Normal or MOS2
- For mini bearings, mode planes & cars toys, automotive & marine parts, etc



**SA9025**

### 2 In 1 Single & Continuous Shot Air Grease Gun w/ 6" Curved Pipe w/ 9" Flexible Hose

**SA9025-PC**

### 2 In 1 Single & Continuous Shot Air Grease Gun w/Clear Tube w/ Flexible Hose w/ Spring Guard

- 40:1 ratio air motor
- 3-way loading: Bulk, filler pump or 14oz grease cartridge
- Bleeder Valve for purging unwanted air
- Durable follower rod & spring for consistent priming
- Postitive grip follower handle
- 4-Jaw super grip coupler for better grip and longer service life
- Single Shot Mode: Max - 4800psi
- Continuous Shot Mode: Max -2500psi

- Capacity of Cartridge: 400cc/ 14.oz
- Capacity of Bulk Loading: 450cc
- Continuous Shot Mode:  
Greaseing Flow: 250ml /min
- Weight:1.6kgs
- Air Inlet: 1/4"
- Hose Size: 3/8" I.D.



SA9025

SA9025-PC

**BGB-LB01**

### 2 IN 1 Handy Air Vacuum Lifter & Air Blow Gun

- Suction Cup Size: 40 mm
- Air Pressure: 6.3 kgf/cm<sup>2</sup> (90 psi)
- Capacity: 2 kgs (for smooth iron)
- Weight: 0.31 kg
- Size: 32 x 4 x 5.5 cm (LxWxH)
- Air Cons. : 0.08 m<sup>3</sup>/min (3 SCFM)
- Sound Pressure: 72.6 dBA

- The conventional suction can only apply to smooth surfaces, but the novel vacuum suction can apply to coarse surfaces.apply temperature is 200 degrees centigrade.
- The air suction lifter can work as the air blow gun without using the suction.
- The maximal capacity of the vacuum suction lifter applying to smooth surfaces is up to 2 kgs.
- The vacuum suction can apply to not only objects suction in the water but also water suction.
- With the low air consumption, the 2-in-1 air suction lifter can work with the small 2HP air compressor without the additional vacuum pump (vacuum generator)





# Cleaning Gun

## 清洗槍

**TG216B**  
2 IN 1 Blow / Suction Gun  
w/ Brush



**TG216BS**  
2 IN 1 Blow / Suction Gun  
w/ Brush



**TG220**  
Cyclone Turbo Cleaning Gun  
w/ 1000cc Cup & Nitto Coupler

- Teflon tube aperture:  
OD1.6 x ID1.1 / OD1.35 x ID0.8
- Applicable to Acid & Alkaline Solvent.



**TG220U**  
Cyclone Turbo Cleaning Gun  
w/ 1000cc Cup &  
720° Swivel Connector

- Teflon tube aperture:  
OD1.6 x ID1.1 / OD1.35 x ID0.8
- Applicable to Acid & Alkaline Solvent.



**TG218A**  
Mini Blow Gun with Brush



**TG217BD-10**  
**TG217BD-15**  
2 IN 1 Blow / Suction  
w/ 10(15)M  
Double Hose w/ Brush



**TG222K**  
4 IN 1 Air Cleaning Gun

Contents							
1PC	Cleaning Gun	1PC	Vacuum Hose	1PC	Nozzle	1PC	Small-bore Tube
1PC	Foam Set	1PC	Dust Bag	1PC	End Cap	1PC	Brush
1PC	Hose Connector	1PC	Extension Tube	1PC	Valve	1PC	Plug
1PC	Hose Adapter	1PC	Flat Tube	2PCS	Clamping Ring	1PC	Spanner

- Specification
- 1.Foam Cleaning Gun
  - 2.Water Spray Gun
  - 3.Air Blow Gun
  - 4.Vacuum Cleaning Gun
- Air Pressure: 90psi
  - Air Inlet: 1/4



Model No.	Free Speed	Air Inlet	Dimension	Air Pressure	Net Weight	Cup	Avg.Air Cons
	無負載轉速	進氣口	長x寬x高	空氣壓力	重量	杯	耗氣量
	R.P.M	PT/NPT	mm	psi	kg	L	SCFM
TG216B	5000	1/4"	360x120x275	90	1.2	1	9
TG216BS	5000	1/4"	360x120x275	90	1.2	1	9
TG218A	5000	1/4"	280x47x160	90	0.4	-	9
TG217BD-10	5000	1/4"	360x120x210	90	2.7	-	9
TG217BD-15	5000	1/4"	360x120x210	90	2.7	-	9
TG220	-	1/4"	250x130x220	58-131	0.65	1	-
TG220U	-	1/4"	250x130x220	58-131	0.7	1	-





# Air Blow Gun & Suction Gun

## 氣動吹塵槍 & 吸塵槍

### WG904

#### Air Vacuum Suction / Blow Gun Kit

- Suction: 9cmHg(w/ dust bag)
- Air Inlet: 1/4"
- Air Pressure: 90psi



### WG904K

#### Air Vacuum Suction / Blow Gun Kit

- Air Inlet: 1/4"
- Air Pressure: 90psi



### WG901G

#### High Performance Wonder Gun Kit

- Gun body Weight: 0.67kgs ( 1.47 lbs)
- Length: 145 mm ( Gun body)
- Air Cons: 3.36CFM
- Suction: 9cmHg(w/ dust bag)
- Air Inlet: 1/4"
- Min. Hose Size: 5/16"



### WG906G

#### One-Touch Vacuum Aluminum Air Suction / Blow Gun Kit

- Gun body Weight: 0.8kgs ( 1.76 lbs)
- Length: 145 mm ( Gun body)
- Suction: 9 cmHg (with dust bag)
- Ave. Air Consumption: 3.36 CFM
- Min. Hose Size: 5/16 "
- Air Pressure: 90-435psi



### WG905G

#### Air Vacuum And Blower Gun Kit

- Quick Changes From Vacuum To Blower



### WG903G KIT

#### Air Wonder Gun Kit





# Air Blow Gun

## 氣動吹塵槍

**BGB34**  
Air Blow Gun w/ 50cm  
Metal Reinforcement



**BGB35**  
Air Blow Gun Expansion  
Size:27-39cm



**BGZF-130L 5"**  
**BGZF-300L 12"**  
**BGZF-600L 24"**  
**BGZF-900L 35"**  
Air Blow Gun



**BGCR-130L 5"**  
**BGCR-250L 10"**  
**BGCR-300L 12"**  
**BGCR-600L 24"**  
**BGCR-900L 35"**  
Air Blow Gun



**BGH-01-6**  
**BGH-01-8**  
Industrial High Volume  
Air Nozzle

- Applicable for any air blow guns with Ø6 or 8mm pipes.
- Material: Aluminum
- Length: 85mm



**BGH123-6**  
**BGH123-8**  
Industrial High Volume  
Air Blow Gun w/ Gun Rack

- Air Nozzle is slidable
- Air Volume Regulator
- Aluminum body, Stainless grip
- Pipe: Ø6,8mm



**BGH285F-6 , BGH285F-8**  
**BGH357F-6 , BGH357F-8**  
Industrial High Volume  
Air Blow Gun w/ Gun Rack

- Length: 285,357mm
- Pipe: Ø6,8mm



**BGH285B-6 , BGH285B-8**  
**BGH357B-6 , BGH357B-8**  
Industrial High Volume  
Air Blow Gun w/ Gun Rack

- Length: 285,357mm
- Pipe: Ø6,8mm



**BGB603-4 4"**  
**BGB603-10 10"**  
**BGB603-16 16"**  
Side Hole Air Blow Gun

- Max Pressure: 170PSI(12kg/cm<sup>2</sup>)
- Avg Air Cons: 5CFM



**BGB603-2K**  
Air Blow Gun w/ 11 Tip

- Max Pressure: 230PSI(16kg/cm<sup>2</sup>)
- Avg Air Cons: 8CFM



**BGB601-4SK**  
Air Blow Gun w/ 7 Tip



**BGB603-BR**  
Air Blow Gun w/ Brush

- Air Pressure: 90PSI(6.3Bar)
- Air Cons: 5CFM



**BGB603-BR10 10"**  
Air Blow Gun w/ Brush

- Air Pressure: 90PSI(6.3Bar)
- Air Cons: 5CFM



**BGB602-BR16**  
16" Air Blow Gun w/ Brush

- Air Pressure: 90PSI(6.3Bar)
- Air Cons: 5CFM





# Air Blow Gun

氣動吹塵槍

**BGB13-10**  
Air Blow Gun



**BGB13-11**  
Air Blow Gun



**BGB13-12**  
Air Blow Gun



**BGB13-13**  
Air Blow Gun



**BGB13-14**  
Air Blow Gun



**BGB13-15**  
Air Blow Gun



**BGB13-16**  
Air Blow Gun



**BGB13-17**  
Air Blow Gun



**BGB13-22**  
Air Blow Gun



**BGB13-25**  
Air Blow Gun



**BGB13-27**  
Air Blow Gun



**BGB13-29**  
Air Blow Gun



**BGB13-31**  
Air Blow Gun



**BGB13-32**  
Air Blow Gun



**BGB13A 5"**  
**BGB13A-12 12"**  
Air Blow Gun  
w/ Metal Reinforcement

- Zinc Air Inlet
- Max Pressure: 170PSI



**BGB12 5"**  
**BGB12-12 12"**  
Air Blow Gun  
w/ Quick Coupler

- Plastic Air Inlet
- Max Pressure: 170PSI







# Air Blow Gun

## 氣動吹塵槍

www.airprotool.com

**BGB127-AL**  
Aluminum Air Blow Gun

- Max Air Pressure: 185PSI

**BGB126** 115mm  
**BGB126-255** 255mm  
**BGB126-300** 300mm  
**BGB126-400** 400mm  
**BGB126-508** 508mm  
**BGB126-1080** 1080mm  
 Air Composite Blow Gun

**BGB1262L** 115mm  
**BGB126-2552L** 255mm  
**BGB126-3002L** 300mm  
**BGB126-4002L** 400mm  
**BGB126-5082L** 508mm  
 Air Composite Blow Gun  
 w/ High Flow Nozzle



**BGB125-215** 215-305mm  
**BGB125-295** 295-500mm  
**BGB125-415** 415-750mm  
**BGB125-545** 545-1000mm  
 Swivel-Telescoping  
 Composite Air Blow Gun

**BGB125SA**  
Air Blow Gun w/ Safety Nozzle

**BGB1251W**  
Air Blow Gun  
w/ Adjustable Nozzle



**BGB1252W**  
Air Blow Gun  
w/ Adjustable & 11cm Nozzle

**BGB125S6**  
Air Blow Gun  
w/ Spe.Nozzle

**BGB1252L**  
Air Blow Gun  
w/ High Flow Nozzle

**BGB1253L**  
Air Blow Gun  
w/ High Flow Nozzle





# Air Blow Gun

氣動吹塵槍

**BGB80 4"**  
**BGB80-14 14"**  
Adjustable High Flow  
Air Blow Gun

- Zinc Air Inlet
- Max Pressure:  
16Bar(1.6MPa 230PSI)
- Air Flow: 1175L/m@150PSI



**BGB80-A**  
Adjustable Flow Safety  
Air Blow Gun w/ Standard Nozzle



**BGB80-B**  
Adjustable Flow Safety  
Air Blow Gun w/ Safety Nozzle



**BGB80-C**  
Adjustable Flow Safety  
Air Blow Gun w/ High Flow Nozzle



**BGB80-E**  
4" Adjustable Flow Air Blow Gun  
w/ Rubber Tip



**BGB80-S**  
5cm Adjustable Flow Air Blow Gun



**BGB90C-7**  
High Flow Air Blow Gun  
w/ Quiet Safety Nozzle



**BGB90C-12**  
High Flow Air Blow Gun  
w/ Safety Nozzle



**BGB90C-14**  
High Flow Air Blow Gun  
w/ Adjustable Safety Nozzle



**BGB90C-20**  
High Flow Air Blow Gun  
w/ Safety Nozzle



**BGB90 5cm**  
**BGB91 25cm**  
High Flow Air Blow Gun



**BGB90-E**  
5cm High Flow Air Blow Gun  
w/ Rubber Tip





# Digital Tire Inflator

## 數位胎壓計

www.airprotool.com

### PGD-31

#### NEW IPHONE Blue Tooth Digital Tire Pressure Gauge

**Feature:**

- Body: Plastic & TPR
- Body Size: 124x37 mm ,Weight: 52 g

**Specification:**

- Large LCD Display for Easy Reading
- Unit Changeable: Psi-Bar-Kpa-Kg/cm<sup>2</sup>
- Pressure Increments: 0.5PSI / 0.05Bar, 5 Kpa / 0.05 Kg/cm<sup>2</sup>
- Max Detectable Pressure:200 PSI/13.8Bar, 1,379Kpa/14kg/cm<sup>2</sup>
- Auto-Shutdown: after 30 seconds
- Backlight time: 30 seconds
- With Temperature Compensation function
- Supply Voltage: two 3.0V Battery. (CR2032)
- Measuring Range form 0-200 PSI (+/- 1PSI)



### PGD-02APP

#### NEW IPHONE Blue Tooth Digital Tire Pressure Gauge

**Feature:**

- Body Plastic Gun.
- Air Inlet: 1/4" Male
- Operating Pressure: 90 PSI.
- Air Flow 1.54 CFM at 100 PSI.

**Specification:**

- Unit Changeable: Psi-Bar-Kg/cm<sup>2</sup>-Kpa
- Pressure Increments: 0.5PSI / 0.05Bar / 5 Kpa.
- Clear, LCD Display
- Temperature Range: -10°C ~ 45°C
- Supply Voltage:1.5Vx2 (#4 battery)
- Measuring Range form 0-160 PSI (+/-2%,@25°C)
- Hose Rotation & Clip Tip <360 Degree swivel function>.
- <Hose 50 cm. W.P. W/200PSI>



### PGD-30

#### Digital Tire Pressure Gauge

**Feature:**

- Body: Plastic & TPR
- Body Size: 124x37 mm , Weight: 49g

**Specification:**

- Unit Changeable: Psi-Bar-Kpa-Kg/cm<sup>2</sup>
- Pressure Increments: 0.5PSI / 0.05Bar / 5 Kpa.
- Automatic Shut off After 90 Seconds of Non-Usage to Conserve Battery Life
- Large LCD Display for Easy Reading
- LED:
- Temperature Range: -10°C ~ 45°C
- Supply Voltage: two 3.0V Battery. (CR2032)
- Measuring Range form 0-200 PSI (+/- 1PSI)



### PGD-33

#### Digital Tire Inflator - 11Pcs Accessory

**1. Digital Tire Inflator**

- Function: Inflation , Deflating , Measuring
- Gauge:Rubber Protected 2" Large LCD Display
- Measure Range: 0-100 PSI , 0-7.0 BAR , 0- 0.7 Mpa
- Measuring Range form 0-100 PSI (+/-2%,@25°C)
- Supply Voltage: 3.0 V DC Battery<CR2032>.
- Robber Hose 43CM <W.P. W/200PSI> & Clip <360 Degree swivel function>.

**2. H.D. Blow Gun Extension Tube**

- H.D. Blow Gun 46 cm. <Body 18 cm>
- Plastic Extension Tube 18 to 27 cm

**3. Tire Thread Depth Gauge (AHT-00015)**

- The tyre thread depth (tyre veins depth) has great significance for safe driving.

**4. 1/4" QC Body (F)**

- 5. Dual Chuck**
- 6. 2PCS : 1/4" QC Plug (M)**
- 7. 2PCS : 1/4" QC Plug (F)**
- 8. Teflon Tape**
- 9. 1/4" Air Hose 12 ft**



### PGD-24

#### 3-Function Tire Gauge

**Features:**

- Body ZINC & TPR
- Air Inlet: 1/4" Female
- Operating Pressure: 90PSI
- Air Flow: 1.6 CFM at 100PSI

**Specification:**

- Pressure Uits: only one of PSI;Bar;Kpa Can be Preset in Fact
- Pressure Increments: 0.5PSI/0.05Bar/5Kpa
- Measuring Range from: 0-160 PSI (+/-2%,@25°C)



### PGD-25

#### Tire Inflator With Deflator

**Features:**

- Body ZINC & TPR
- Air Inlet: 1/4" Female
- Operating Pressure: 90PSI
- Air Flow: 1.15 CFM at 100PSI

**Specification:**

- Heavy Duty Aluminium Die Cast Body
- Gauge Measure Range: 0-150 PSI/0-10 Bar/0-1050 Kpa
- Spiral Protect Air Hose: 39CM
- Dual Chuck: 9-1/2"



### PGD-32

#### Heavy Duty Digital Tire Inflator

**Feature :**

- Body ZINC & TPR
- Air Inlet: 1/4" Female
- Operating Pressure: 90 PSI.
- Air Flow 1.15 CFM at 100 PSI.

**Specification:**

- Large LCD Display for Easy Reading
- Pressure Increments: 0.5PSI / 0.05Bar,0.05kg/cm<sup>2</sup> / 5 Kpa.
- Automatic shut off after 60 seconds of to conserve battery life.
- Temperature Range: -10°C ~ 45°C
- Measuring Range from 0-160 PSI (+/-2%,@25°C)
- Supply Voltage: 1.5V <CR2032 battery>
- Hose Rotation & Clip Tip <360 Degree swivel function>.
- <Hose 39 cm. W.P. W/200PSI>







# Spring Balancer & Tool Accessory

## 彈簧吊車 & 配件

### HR11UB / HR12UB Series Spring Driven Air Hose Reel

- Type: Close version
- Case: Plastic (ABS)
- Tube: Polyurethane Braided
- Max Working Pressure: 200psi / 15bar
- Brake Pressure: 800psi / 60bar

Model No.		Description	Spindle
HR11UB6508	HR12UB6508	6.5x10x8M	1/4" Male
HR11UB6510	HR12UB6510	6.5x10x10M	1/4" Male
HR11UB6512	HR12UB6512	6.5x10x12M	1/4" Male
HR11UB8008	HR12UB8008	8x12x8M	1/4" Male



### SB K Series Super Duty Metal Housing Spring Balancer

- Rope Option: Cable
- Rope Dia.: 4.8mm

Model No.	Capacity	Weight	Travel
SB220K	15-22 kg	7.7 kg	1.3 m
SB300K	22-30 kg	8.3 kg	1.3 m
SB400K	30-40 kg	9.7 kg	1.5 m
SB500K	40-50 kg	10.1 kg	1.5 m
SB600K	50-60 kg	11.1 kg	1.3 m
SB700K	60-70 kg	11.4 kg	1.5 m



### HR02E Series Reinforced PVC Air & Water Hose Reel w/ Rotary Base

- Working Pressure: Safety factor 3 to 1
- Temperature Range: -25 to 60°C
- 360° EZ-Swivel Base
- Construction  
Tube: PVC compound  
Reinforcement:  
Spiral polyester yarn  
Cover: PVC compound in color

Package Length: 10, 15, 20, 30M

Model No.	Hose ID	Hose OD	Max Working Pressure at 23°C	Min. Burst Pressure at 23°C	Package Length(mm)	Thread
	mm	mm				PT/NPT
HR02E65107	6.5	10.7				1/4
HR02E80125	8	12.5	20 bar	60 bar	10,15,20,30	1/4
HR02E10150	10.5	15				3/8



### ACC-16 32 Teeth ACC-17 24 Teeth ACC-18 18 Teeth 5PCS Saw Blade Set w/ Hole



### PAD-02 4" Eraser Rubber Pad

- Thread: 5/16"x24
- PRM: 4000



### PAD-02-ADAPTER Mandrel For PAD-02

- Thread: 5/16"x24
- Shank: 6mm



### PAD-02K 4" Eraser Rubber Pad w/ Mandrel

- Thread: 5/16"x24
- PRM: 4000



### PAD-03 Deluxe Eraser Wheel

- Thread: 5/16"x24



### PAD-04 4" Eraser Wheel

- Thread: 5/16"x24
- PRM: 2000-3500
- Thickness: 23mm



### E50620-10 5" Soft Interface Pad

- Hole: 6
- PRM: 12000



### E60620-10 6" Soft Interface Pad

- Hole: 6
- PRM: 12000



### E61620-10 6" Soft Interface Pad

- Hole: 6+1
- PRM: 12000



### E61820-10 6" Soft Interface Pad

- Hole: 8+1
- PRM: 12000



### E61820-15 6" Soft Interface Pad

- Hole: 14+1
- PRM: 12000





# Vinyl & Velcro Pad

## 自黏 & 黏扣托盤

www.airprotool.com

**PAD-4014/ PAD-4024**  
4" Vinyl / Velcro Sanding Pad

- Thread: 5/8"x11, M10x1.25, M10x1.5, M14x2.0, M16x2.0
- PRM: 15000



**PAD-4514/ PAD-4524**  
4-1/2" Vinyl / Velcro Sanding Pad

- Thread: 5/8"x11, M10x1.25, M10x1.5, M14x2.0, M16x2.0
- PRM: 10000



**PAD-5014/ PAD-5024**  
5" Vinyl / Velcro Sanding Pad

- Thread: 5/8"x11, M10x1.25, M10x1.5, M14x2.0, M16x2.0
- PRM: 10000



**PAD-6014/ PAD-6024**  
6" Vinyl / Velcro Sanding Pad

- Thread: 5/8"x11, M14x2.0, M16x2.0
- PRM: 10000



**PAD-301AU/ PAD-302AU**  
3" Vinyl / Velcro Sanding Pad

- Thread: 5/16"x24
- PRM: 15000
- Thickness: 15mm



**PAD-351 / PAD-352**  
3-1/2" Vinyl / Velcro Sanding Pad

- Thread: 5/16"x24
- PRM: 15000
- Thickness: 10mm



**PAD-5044**  
5" Velcro Face Pad

- Thread: 5/16"x24
- PRM: 12000
- Hole: 44 inside
- Thickness: 10mm



**PAD-6052**  
6" Velcro Face Pad

- Thread: 5/16"x24
- PRM: 12000
- Hole: 52 inside
- Thickness: 10mm



**UF501A/ UF502A**  
5" Vinyl / Velcro Sanding Pad

- Thread: 5/16"x24
- PRM: 12000
- Thickness: 16mm



**PAD-561/ PAD-562**  
5" Vinyl / Velcro Sanding Pad

- Thread: 5/16"x24
- PRM: 12000
- Hole: 6
- Thickness: 10mm



**PAD-601A/ PAD-602A**  
6" Vinyl / Velcro Sanding Pad

- Thread: 5/16"x24
- PRM: 12000
- Thickness: 16mm



**PAD-661/ PAD-662**  
6" Vinyl / Velcro Sanding Pad

- Thread: 5/16"x24
- PRM: 12000
- Hole: 6
- Thickness: 10mm



**PAD-6161A/PAD-6162A**  
6" Vinyl / Velcro Sanding Pad

- Thread: 5/16"x24
- PRM: 12000
- Hole: 6 side/6 inside
- Thickness: 10mm



**PAD-6181B/ PAD-6182B**  
6" Vinyl / Velcro Sanding Pad

- Thread: 5/16"x24
- PRM: 12000
- Hole: 8+1
- Thickness: 10mm



**PAD-6181A/ PAD-6182A**  
6" Vinyl / Velcro Sanding Pad

- Thread: 5/16"x24
- PRM: 12000
- Hole: 8 side/15 inside
- Thickness: 10mm



**PAD-61171/PAD-61172**  
6" Vinyl / Velcro Sanding Pad

- Thread: M8x1.0, 5/16"x24
- PRM: 12000
- Hole: 17 inside
- Thickness: 10mm



**PAD-3014/ PAD-3024**  
3" Vinyl / Velcro Sanding Pad

- Thread: 5/8"x11, M10x1.25, M10x1.5, M14x2.0, M16x2.0, 6mm x1.0, 1/4"x20
- PRM: 20000



**PAD-7014/PAD-7024**  
7" Vinyl / Velcro Sanding Pad

- Thread: 5/8"x11, M14x2.0, M16x2.0
- PRM: 8500



**PAD-7A14/PAD-7A24**  
7" Vinyl / Velcro Sanding Pad

- Thread: 5/8"x11, 14x2.0, M16x2.0
- PRM: 8500



**SDBA7004/SDBA7014/SDBA7024**  
7" Cloth / Vinyl / Velcro Sanding Pad

- Thread: 5/8"x11, M14x2.0, M16x2.0
- PRM: 5000
- Thickness: 12mm





# Sanding Pad, Sponge & Wool Pad

## 磨砂盤, 海綿 & 羊毛托盤

### Removal Sanding Pad for Disc Holder

- Aluminum Oxide
- Yellow- Coarse
- Red-Medium
- Green-Fine



Model No.	Dia	RPM	
C2013			Coarse
C2023	2"	30000	Medium
C2033			Fine
C3013			Coarse
C3023	3"	20000	Medium
C3033			Fine
C4013			Coarse
C4023	4"	10000	Medium
C4033			Fine

### Abrasive Disc for Rollon Holder

- AA203-100 Aluminum Oxide
- AS203-100 Silicon Carbide



Model No.	Dia	RPM	
AA203-100	2"	30000	Grit: #24 , #400
AS203-100			
AA303-100	3"	25000	
AS303-100			
AA403-100	4"	10000	
AS403-100			

### PAD-315K

#### 3" Sander & Buffer Versatility Kit



Contents	
1PC	Roll on holder (6mm or 1/4")
1PC	3" Sanding Pad
1PC	Wool Buff + Sponge (Each)
10PCS	Abrasive Paper

### PAD-302PK

#### 3" Sander & Buffer Versatility Kit



Contents	
1PC	3" Sanding Pad
6PCS	Sanding Sponge
10PCS	Sanding Paper
2PCS	Polishing Sponge

### PAD-302DPK

#### 3" Sander & Buffer Versatility Kit



Contents	
1PC	3" Sanding Pad(6mm or 1/4")
6PCS	Sanding Sponge
10PCS	Sanding Paper
2PCS	Polishing Sponge

### PAD-302AK

#### 3" Sander & Buffer Versatility Kit



Contents	
1PC	3" Sanding Pad (6mm or 1/4" or 5/16")
1PC	Wool Buff + Sponge (Each)
10PCS	Abrasive Paper

### Sponge With Velour Backing



Model No.	Dia	Thickness	Color
PAD-EL200Y-25 / PAD-EL200W-25	2"	25mm	Yellow / White
PAD-EL300Y-25 / PAD-EL300W-25	3"		
PAD-EL400Y-25 / PAD-EL400W-25	4"		
PAD-EL500Y-25 / PAD-EL500W-25	5"		
PAD-EL600Y-25 / PAD-EL600W-25	6"		
PAD-EL700Y-25 / PAD-EL700W-25	7"		
PAD-EL800Y-25 / PAD-EL800W-25	8"		

### Wool Pad



Model No.	Dia	Type
PAD-FL200	2"	Velour Backing
PAD-FL300	3"	Velour Backing
PAD-FL500 / PAD-FL508	5"	Velour Backing / Tie On
PAD-FL700 / PAD-FL708	7"	Velour Backing / Tie On





# Vacuum Hand Sander

## 抛光板

### SBV-SC1

#### Vacuum Hand Sander

- Size: 70x125mm(WxL)
- Air Inlet: 20mm
- Backing: Vinyl or Velcro

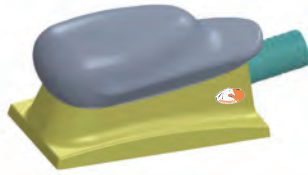

### SBV-SC2

#### Vacuum Hand Sander

- Size: 90x175mm(WxL)
- Air Inlet: 20mm
- Backing: Vinyl or Velcro

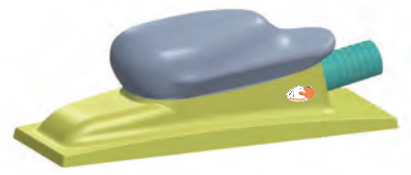

### SBV-SC3

#### Vacuum Hand Sander

- Size: 115x227mm(WxL)
- Air Inlet: 20mm
- Backing: Vinyl or Velcro

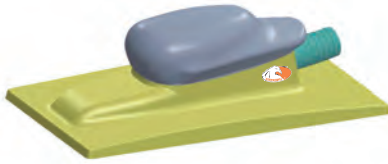

### SBV-SC4

#### Vacuum Hand Sander

- Size: 70x400mm(WxL)
- Air Inlet: 20mm
- Backing: Vinyl or Velcro



### SBV-301

#### Vacuum Hand Sander w/ 15 Hole

- Size: 70x125mm(WxL)
- Air Inlet: 25mm
- Backing: Vinyl or Velcro



### SBV-302

#### Vacuum Hand Sander w/ 12 Hole

- Size: 90x175mm(WxL)
- Air Inlet: 25mm
- Backing: Vinyl or Velcro



### SBV-303

#### Vacuum Hand Sander w/ 10 Hole

- Size: 115x227mm(WxL)
- Air Inlet: 25mm
- Backing: Vinyl or Velcro



### SBV-3011

#### Vacuum Hand Sander w/ 15 Hole

- Size: 70x125mm(WxL)
- Air Inlet: 15 & 30mm
- Backing: Vinyl or Velcro



### SBV-3022

#### Vacuum Hand Sander w/ 12 Hole

- Size: 90x175mm(WxL)
- Air Inlet: 15 & 30mm
- Backing: Vinyl or Velcro



### SBV-3033

#### Vacuum Hand Sander w/ 10 Hole

- Size: 115x227mm(WxL)
- Air Inlet: 15 & 30mm
- Backing: Vinyl or Velcro



### SBV-3044

#### Vacuum Hand Sander w/ 16 Hole

- Size: 80x133mm(WxL)
- Air Inlet: 15 & 30mm
- Backing: Vinyl or Velcro



### SBV-3055

#### Vacuum Hand Sander w/ 11 Hole

- Size: 70x195mm(WxL)
- Air Inlet: 15 & 30mm
- Backing: Vinyl or Velcro





# Water Base LVLP & HVLP Spray Gun

## 水性LVLP & HVLP 噴槍

### AM7000HVLPK / AM7000HVLWPBK AM7000LVLPK / AM7000LVLWPBK

#### Gravity Feed Spray Gun Kit

Contents	
1PC	AM7000(HVLP)(LVLP) Gravity Feed Spray Gun Set Up One Nozzle (1.3 Nozzle Size)
1PC	0.6 Liter Nylon Cup
2PCS	Extra Nozzle Kit For Optional
3PCS	Stainless Steel Strainers
1SET	Spray Gun Repair Kit
1PC	R11 Regulator
1PC	Brush
1PC	Wrench
1PC	Hex Wrench
1PC	Triangle Ring
1PC	Swivel Plug
1PC	Integrated Blow Molded Case

### AM7000K / AM7000WBK

#### Gravity Feed Spray Gun Kit

Contents	
1PC	AM7000(WB) Gravity Feed Spray Gun Set Up One Nozzle (1.3 Nozzle Size)
1PC	0.6 Liter Nylon Cup
2PCS	Extra Nozzle Kit For Optional
6PCS	Stainless Steel Strainers
1SET	Spray Gun Repair Kit
1PC	Brush
1PC	Wrench
1PC	Hex Wrench
1PC	Triangle Ring
1PC	Swivel Plug
1PC	Integrated Blow Molded Case

#### Feature:

- Superior atomization
- Die cast alum gun body with chrome plating
- Stainless steel fluid nozzle & needle.
- AM7000HVLWPBK & AM7000HVLPK: Air Cap Pressure <10 Psi



Model No.	Standard Fluid Nozzle Size	Optional Nozzle Size	Air Pressure		Air Cons	
	mm	mm	Bar	psi	CFM	L/min
AM7000LVLWPBK	1.4	1.0, 1.2, 1.3, 1.5, 1.7, 1.9, 2.2	2	29	10	283
AM7000HVLWPBK	1.4	1.0, 1.2, 1.3, 1.5, 1.7, 1.9, 2.2	2	29	10	283
AM7000WBK	1.3	1.0, 1.2, 1.4, 1.6, 1.8, 2.0, 2.5	2.5	35	11.5	325
AM7000LVLPK	1.4	1.0, 1.2, 1.3, 1.5, 1.7, 1.9, 2.2	2	29	10	283
AM7000HVLPK	1.4	1.0, 1.2, 1.3, 1.5, 1.7, 1.9, 2.2	2	29	10	283
AM7000K	1.3	1.0, 1.2, 1.4, 1.6, 1.8, 2.0, 2.5	2.5	35	11.5	325

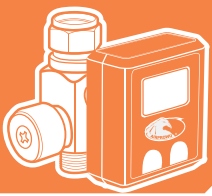

# Air Regulator & Gauge

## 數位壓力錶

www.airprotool.com

### R71G 33mm Digital Gauge

- Withstand Pressure: 200psi
- Pressure Range: 0~120psi ; 0~8.28bar ; 0~828KPa
- Max. Pressure: 250psi
- Applicable fluid: Filtered air, incombustible and non-corrosive gases.
- Battery: 15 VDC battery x 2pcs(battery can't replaceable)
- Battery life: 3 Year(1hours/day)
- Ambient temp. Operation: 0~45°C ,Storage: -10~60°C
- Display turn off after 90 sec.



### R71C 33mm Digital Gauge w/ Air Regulator



### R71D 33mm Digital Gauge w/ Air Regulator



### R71H 33mm Digital Gauge w/ Air Regulator



### R70G 3x3cm Digital Gauge

- Pressure Range: 0.000 ~ 1.000mpa
- Withstand pressure: 1.5mpa
- Accuracy:  $\leq \pm 2\%$  F.S.  $\pm 1$  digit @25 $\pm 3^\circ\text{C}$
- Applicable fluid: Filtered air, incombustible and non-corrosive gases
- Battery: CR 2032 lithium(battery replaceable)
- Battery life: 1 Year(5 times/day)
- Ambient temp. Operation: 0~50°C ,Storage: -10~60°C
- Display turn off after 30 sec.



### R71F 33mm Digital Gauge w/ Air Regulator



### R70 Air Regulator w/ 3x3cm Digital Gauge



### R72 Air Regulator w/ 3x3cm Digital Gauge



### R73 Air Regulator w/ 3x3cm Digital Gauge



### R74 Air Regulator w/ 3x3cm Digital Gauge







# Air Line Schematic & Warranty Information

## 氣動空壓連接系統 & 保固資訊



### AIR TOOLS/ ONE YEAR LIMITED WARRANTY :

- The manufacture warrants this equipment to the original user against defective material or workmanship for a period of one year from the date of purchase on repair parts and labor.
- The manufacturer's responsibility under this warranty is limited to the repair or replacement of defective part or parts.
- The manufacturer reserves the right to determine whether the part or parts failed because of defective material workmanship or other causes. Failures caused by accident, alteration, misuse or improper packing or returned units are not covered by this warranty.
- All warranty repairs must be done by AIRPRO or AIRPROWU pneumatic tool service agents or by AIRPRO or AIRPROWU any repair to the equipment other than by these authorized facilities voids this warranty. The rights under this warranty are limited to the original user and may not be transferred to subsequent owners.

### AIR LINE SCHEMATIC

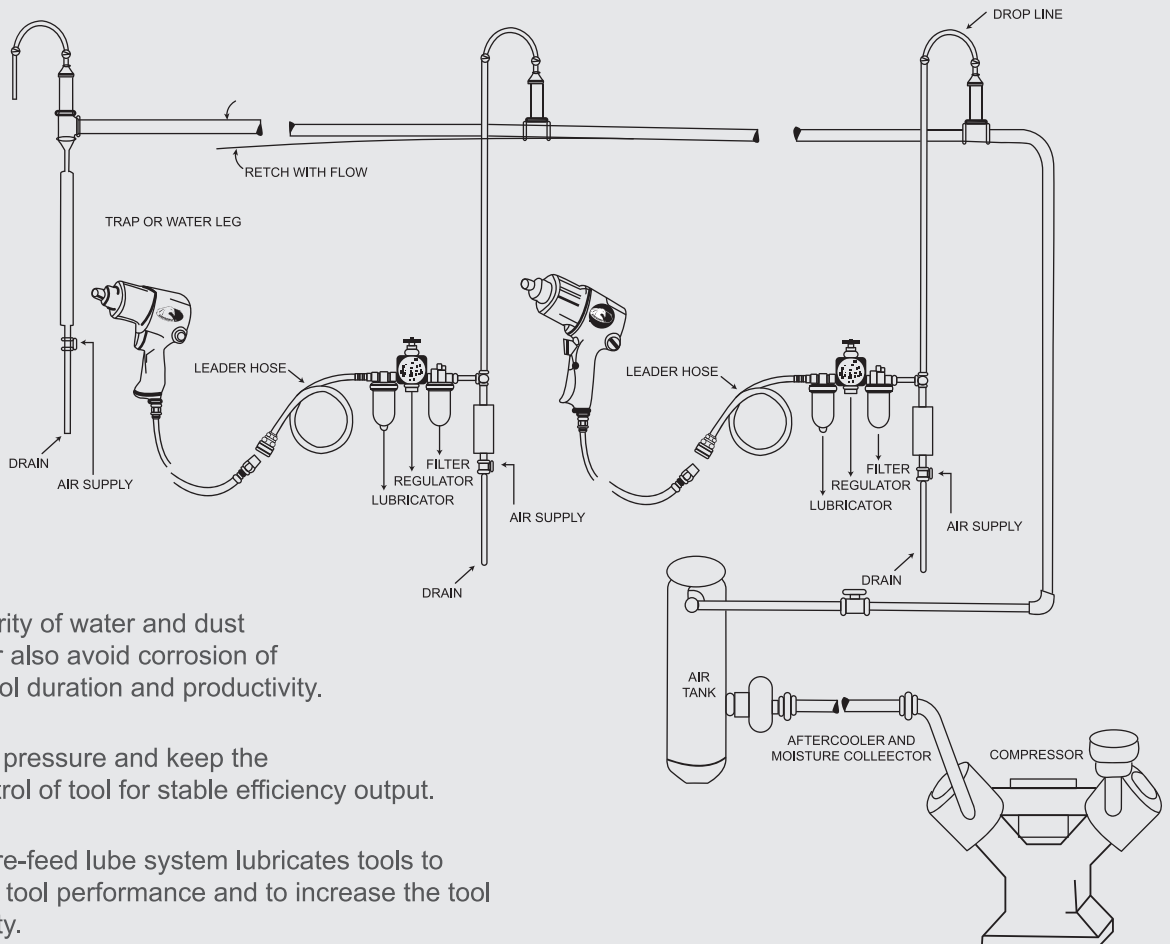

#### FILTER

Remove the majority of water and dust motes from the air also avoid corrosion of tool to increase tool duration and productivity.

#### REGULATOR

Maintain selected pressure and keep the critical speed control of tool for stable efficiency output.

#### LUBRICATOR

Automatic pressure-feed lube system lubricates tools to maintain optimum tool performance and to increase the tool life and productivity.

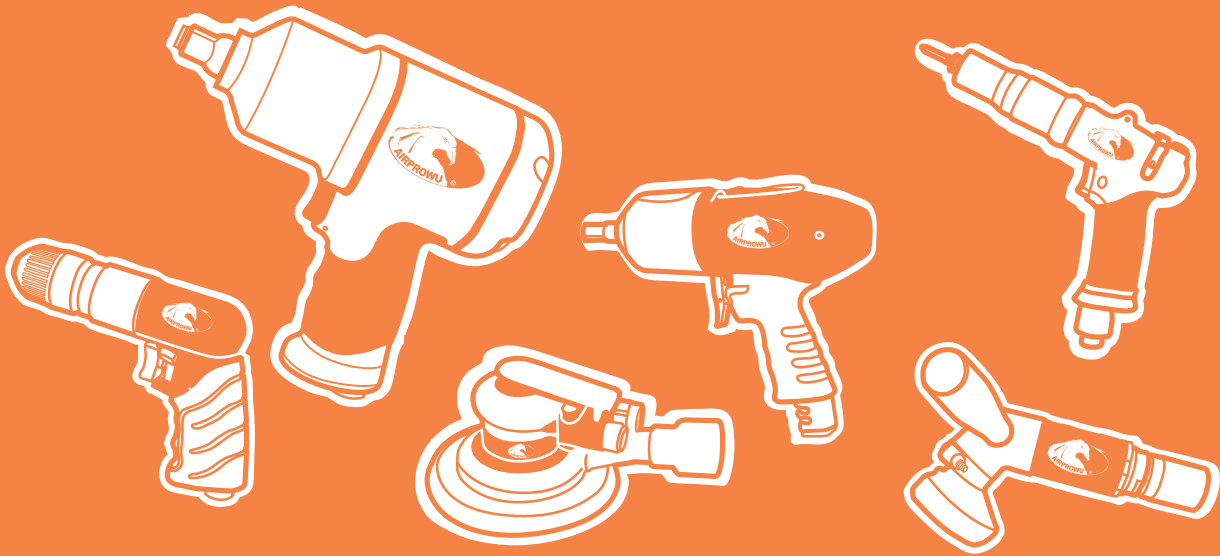

## AIRPRO INDUSTRY CORP.

Manufacture and Export of Professional Tools

 6F-2 No.158 Kancheng Rd.,Panchiao District,New Taipei City,  
Taiwan 22061

 Tel No : 886-2-29504785  Fax No : 886-2-89533145

 Skype : airprotool

 E-mail: sales@airprotool.com / sales@airprowu.com

 www.airprotool.com

